

# STEEL HOOK BASE 32 W RPB-2 ATTACHMENT - HOOK-BASE-32-RPB-2

APPROX WEIGHT: 124.93 lbs.

DOES NOT INCLUDE WEIGHT OF POWER OR PACKAGING!!!

\*\*\* ANY ADDITIONS, DELETIONS, OR OMISSIONS MUST BE CORRECTED ON THIS DRAWING AS THIS DRAWING WILL BE CONSIDERED ALL INCLUSIVE \*\*\*

ALL GRAPHICS PROVIDED ARE FOR REFERENCE ONLY. IF CERTAIN DIMENSIONS ARE CRITICAL PLEASE VERIFY THOSE DIMENSIONS WITH YOUR SALESPERSON

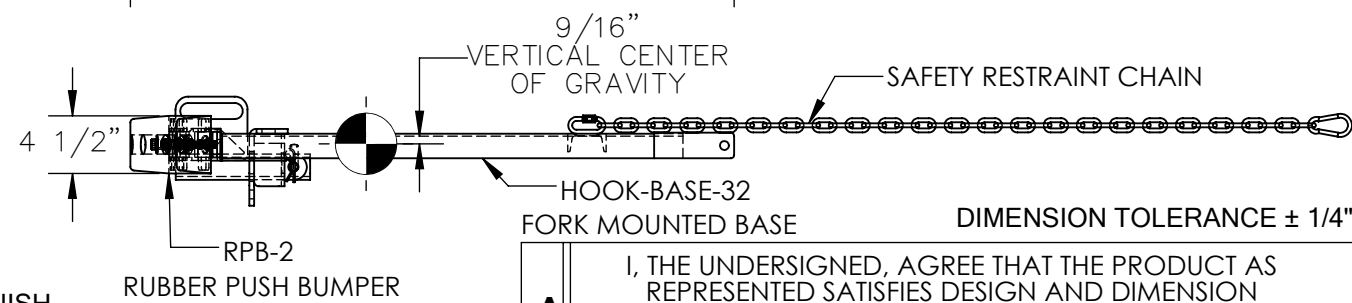
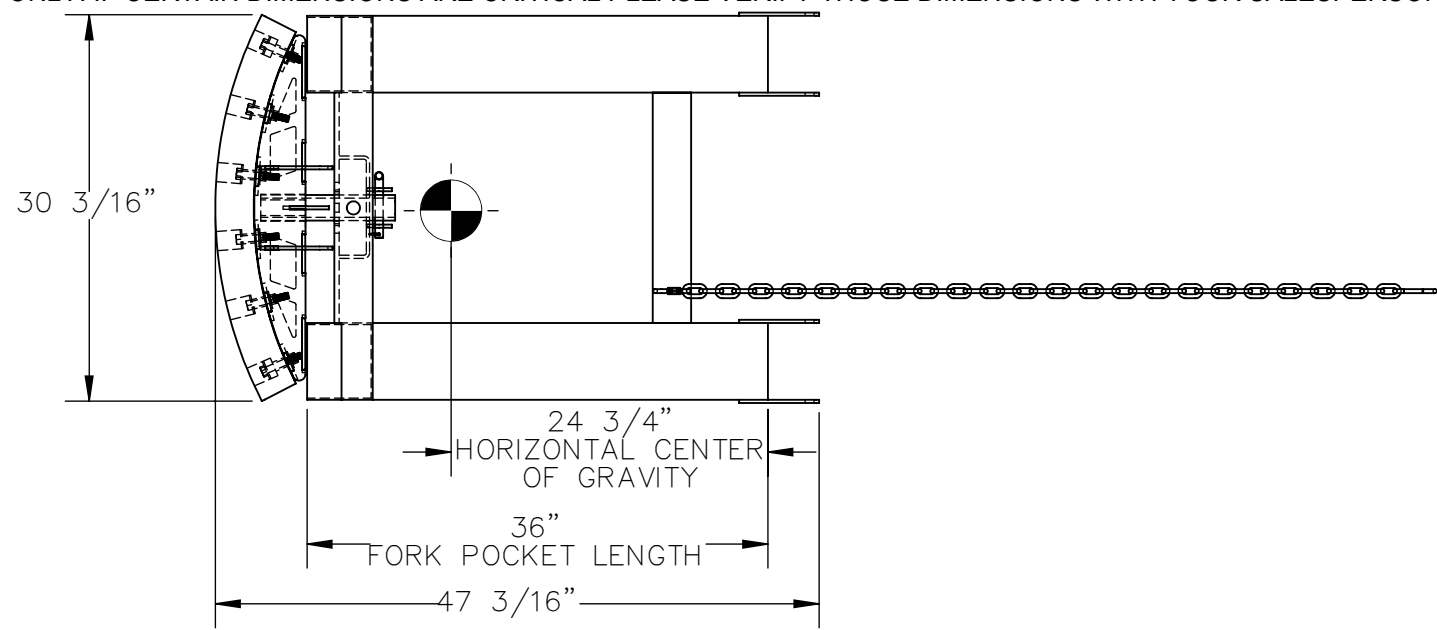
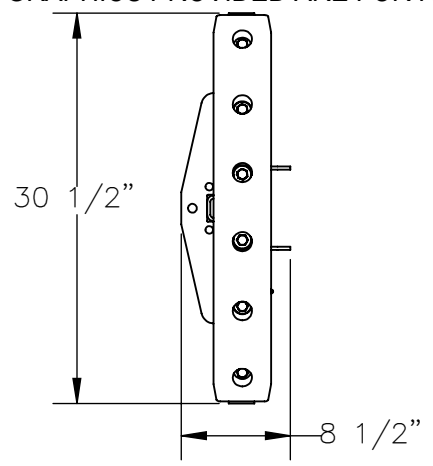

## STANDARD FEATURES

- MODEL NUMBER IS HOOK-BASE-32-RPB-2
- OVERALL WIDTH IS 30 1/2"
- USABLE WIDTH IS 30 3/16"
- OVERALL LENGTH IS 47 3/16"
- OVERALL HEIGHT IS 8 1/2"
- USABLE HEIGHT IS 4 1/2"
- ACCOMODATES UP TO A 5" WIDE x 2" THICK FORK
- SAFETY RESTRAINT CHAIN
- MINIMUM FORK LENGTH IS 36"
- BASE: DURABLE BAKED IN POWDER COATED BLUE FINISH
- ATTACHMENT: DURABLE BAKED IN POWDER COATED YELLOW FINISH

APPROX. WEIGHT / LOST LOAD = 124.93 LBS  
 MINIMUM EFFECTIVE THICKNESS = FORK LENGTH - 36"  
 VERTICAL CENTER OF GRAVITY = 9/16"  
 HORIZONTAL CENTER OF GRAVITY = 24 3/4"

NEVER EXCEED LOAD CENTER  
 RATING PER FORKTRUCK  
 MANUFACTURERS GUIDELINES.  
 DO NOT USE THIS FORK TRUCK  
 ATTACHMENT IF LOAD WILL EXCEED  
 FORK TRUCK MANUFACTURER'S  
 LOAD CENTER RATING

## SPECIAL FEATURES

NONE

DIMENSION TOLERANCE ± 1/4"

<b>A P P R O V A L</b>	I, THE UNDERSIGNED, AGREE THAT THE PRODUCT AS REPRESENTED SATISFIES DESIGN AND DIMENSION REQUIREMENTS. I ALSO ACKNOWLEDGE MY DUTY TO CONFIRM PRODUCT AND INSTALLATION COMPLIANCE WITH ALL APPLICABLE FEDERAL, STATE AND LOCAL REGULATIONS, AND STANDARDS.	
	<b>UNITS REQUIRING APPROVAL DRAWINGS OR MODIFIED ARE NON-RETURNABLE</b>	
	[ ] As drawn      [ ] As marked	
	Signed: _____ Date: _____	
Printed Name: _____		
<i>LEAD TIME WILL START UPON RECEIPT OF SIGNED APPROVAL DRAWING</i>		

DISTRIBUTOR'S NAME:		P.O.#
<b>VESTIL MANUFACTURING</b>		X
DRAWN BY: <b>AJS</b>		W.O.#
DATE: <b>02/14/2025</b>		X
REFERENCE: <b>X</b>		SALES: <b>X</b>
QUOTED LEAD TIME: <b>X</b>		SCALE: 1:15
QUOTE # <b>X</b>		FILE NAME:
		08-007-519