

# 1.9kW Single-Phase Switched PDU, LX Platform, Outlet Monitoring, 120V Outlets (24 NEMA 5-15/20R), L5-20P Plug, 0U, TAA

MODEL NUMBER: PDUMVR20NETLX

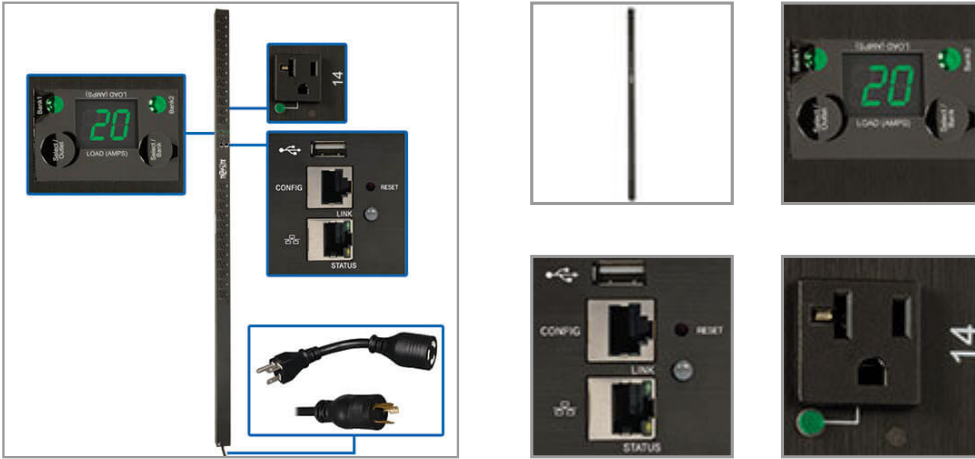

1.9kW vertical PDU with individual outlet metering distributes, monitors and manages single-phase power. Built-in Java-free network interface helps you remotely monitor load levels to prevent overloads that cause downtime.

## Description

The PDUMVR20NETLX 1.9kW Single-Phase Switched PDU with individual outlet metering provides advanced network control and remote power monitoring with the ability to turn on, turn off, reboot or lock out power to each outlet. By reducing the frequency of on-site visits, these advanced remote capabilities can save you money and reduce downtime.

The switched PDU features 24 individually controllable NEMA 5-15/20R outlets with cord retention brackets to prevent cables from becoming accidentally disconnected. A 10-ft. (3.05 m) power cord with NEMA L5-20P plug and optional 5-20P adapter connects the PDU to an AC source, generator or protected UPS.

The built-in Java-free HTML5-based LX Platform network interface enables full remote access for PDU status monitoring and email notifications via secure web browser, SNMP, telnet or SSH. It supports 10/100 Mbps auto-sensing for optimum communication with an Ethernet network. Optional EnviroSense2 modules (sold separately) provide a variety of environmental monitoring capabilities. Protocols supported include IPv4, IPv6, HTTP, HTTPS, SMTP, SNMPv1, SNMPv2, SNMPv3, telnet, SSH, FTP, DHCP and NTP.

A digital ammeter allows you to monitor each load bank's current, each outlet's current and the total connected PDU load in real time to ensure they remain well below maximum capacity with no danger of overload. The switched PDU mounts in 0U of space in EIA-standard 19-inch racks using the included toolless mounting buttons or the included rack-mounting brackets.

## Features

**Distributes, Monitors and Manages Network-Grade AC Power** 1.9kW 120V 20A switched rack PDU (rPDU) with single-phase input 10-ft. (3.05 m) power cord with NEMA L5-20P plug and 5-20P adapter Firmware upgrades support future product enhancements

**24 NEMA 5-15/20R Switched Outlets Distribute AC Power** Individual outlets can be remotely controlled to power up, power down, reboot or lock out devices Included cord retention brackets prevent cables from becoming accidentally disconnected

**Digital Ammeter** Reports current for each load bank, each individual outlet, and total PDU load Supports IP-address self-ID Digits flip 180° for easy reading at either angle

**Built-In LX Platform Interface** Pre-installed WEBCARDLX with the latest version of PowerAlert Device

## Highlights

- 1.9kW 120V single-phase switched 70-inch 0U PDU
- 24 controllable NEMA 5-15/20R outlets in 2 load banks
- Pre-installed WEBCARDLX with latest version of PADM20 for IP-based Auto Probe feature
- Digital ammeter for on-site load monitoring in real time
- 10-ft. (3.05 m) power cord with NEMA L5-20P plug and 5-20P adapter

## Package Includes

- PDUMVR20NETLX 1.9kW Single-Phase Switched PDU
- Built-in LX Platform interface
- NEMA 5-20P plug adapter
- Configuration cable
- Cord retention brackets
- (24) Cable ties
- Rack-mounting hardware
- PDUMVROTATEBRKT mounting bracket accessory
- Owner's manual



Powering Business Worldwide



Manager firmware (PADM20) provides enhanced remote management capabilities PADM20 and PowerAlert Element Manager (PAEM) form a powerful tool for expanding maintenance functions in large installations, including firmware update checks and backup and restoration of device configurations IP-based Auto Probe detects lost connectivity and restores service autonomously

**Broad Communications Compatibility** Supports IPv4, IPv6, HTTP, HTTPS, SMTP, SNMPv1, SNMPv2c, SNMPv3, telnet, SSH, CLI, FTP, DHCP and NTP Supports automatic and manual assignment of IP address

**Essential Safety Features** Tiered access allows administrator and guest to log in via web browser Immediate alert notifications via email or SNMP traps Supports user-specified alarm notification thresholds Real-time clock backup maintains day/date even if PDU is unpowered

**Easy 0U Installation in EIA-Standard 19 in. Racks** 70 in. PDU mounts vertically using included toolless buttons or rack-mounting brackets Included PDUMVROTATEBRKT allows mounting with rear-facing outlets

**TAA-Compliant** Compliant with the Federal Trade Agreements Act (TAA) for GSA Schedule purchases

## Specifications

OVERVIEW	
UPC Code	037332204141
PDU Type	Switched
INPUT	
Input Phase	Single-Phase
PDU Input Voltage	120
Recommended Electrical Service	Single-phase 20A 120V service
Maximum Input Amps	16
Maximum Input Amps Details	Agency de-rated to 16A continuous
PDU Plug Type	NEMA 5-20P; NEMA L5-20P
Input Cord Length (ft.)	10
Input Cord Length (m)	3.05
OUTPUT	
Output Capacity Details	1.92kW (120V) / 16A total capacity; 16A max per outlet
Frequency Compatibility	50 / 60 Hz
Output Receptacles	(24) 5-15/20R
Output Nominal Voltage	120V
Customized Load Management Receptacles	Each outlet is individually controllable via remote interface
USER INTERFACE, ALERTS & CONTROLS	



Powering Business Worldwide



Front Panel LCD Display	Digital display reports load level in amps for LOAD BANK 1 (Outlets 1-12), LOAD BANK 2 (Outlets 13-24), LOAD BANKS 1&2 COMBINED (Outlets 1-24) and each individual output receptacle; Digital display can also be used to scroll the configured IP address
Front Panel LEDs	BANK 1 and BANK 2 LEDs verify which load bank the digital current display is reporting (Bank 1, Bank 2 or Banks 1&2 Combined); BANK 1 or BANK 2 LED will flash when the digital display is reporting output current for one of the outlets in that load bank; 24 additional LEDs, one near each output receptacle, will light continuously to verify power on/off status and flash to indicate that the digital display is reporting output current for just that individual receptacle. LX Platform Interface: Network Link/Activity Status LED (Yellow), Network Speed LED (Green); LX Platform status LED (Green)
Switches	SELECT OUTLET and SELECT BANK switches advance the LCD screen and associated LED to display power consumption for individual output receptacles and output load banks; Press and hold the SELECT BANK button for 4 seconds to rotate the digital display 90 degrees for overhead power input; Press and hold the SELECT OUTLET button for 4 seconds to scroll the configured IP address. LX Platform Interface: Recessed reset switch for interface reboot and factory reset
Current Measurement Accuracy (Amps)	+/-1%
Voltage Measurement Accuracy (Volts)	+/-1%
Power Measurement Accuracy (Watts)	+/-1%
<b>SURGE / NOISE SUPPRESSION</b>	
Automatic Shut-Off	No
<b>PHYSICAL</b>	
Material of Construction	Metal
Rack Height	0U
Form Factors Supported	0U vertical rackmount; includes rackmount brackets. Supports toolless mounting in button-mount compatible racks
PDU Form Factor	Vertical (0U)
Shipping Dimensions (hwd / in.)	4.53 x 6.10 x 75.78
Shipping Dimensions (hwd / cm)	11.51 x 15.49 x 192.48
Shipping Weight (lbs.)	14.93
Shipping Weight (kg)	6.77
Unit Dimensions (hwd / in.)	70.000 x 2.200 x 2.050
Unit Dimensions (hwd / cm)	178 x 5.6 x 5.2
Unit Weight (lbs.)	9.6
Unit Weight (kg)	4.35
<b>ENVIRONMENTAL</b>	
Operating Temperature Range	32° to 104°F (0° to 40°C)
Storage Temperature Range	-22° to 140°F (-30° to 60°C)
Relative Humidity	5% to 95% non-condensing
Operating Elevation	0-10000 ft. (0-3000 m)
<b>COMMUNICATIONS</b>	



Powering Business Worldwide



PowerAlert Software	LX Platform Interface: PowerAlert Device Manager
Communications Cable	RJ45-to-DB9 configuration/console Access cable
Network Monitoring Port	RJ45 Network port, RJ45 Serial Config/Console Access port; USB A port supports a variety of EnviroSense2 environmental and control modules. See Accessories>Management Hardware section for more information about these modules.
SNMP Compatibility	Pre-installed LX platform interface provides remote monitoring via Java-free HTML5 web interface, telnet, SSH and SNMP management systems
Network Compatibility	10 Mbps; 100 Mbps (Fast Ethernet)
<b>FEATURES &amp; SPECIFICATIONS</b>	
High Availability PDU Features	Auto Probe Monitoring and Reboot (included); Auto Load Shedding
<b>STANDARDS &amp; COMPLIANCE</b>	
Product Certifications	CAN/CSA-C22.2 No. 60950-1 (Canada); NOM (Mexico); UL 60950-1
Product Compliance	RoHS; FCC Part 15 Class A (USA); Trade Agreements Act (TAA)
<b>WARRANTY &amp; SUPPORT</b>	
Product Warranty Period (Worldwide)	2-year limited warranty

1000 Eaton Boulevard  
 Cleveland, OH 44122  
 United States  
<https://tripplite.eaton.com>

© 2024 Eaton. All Rights Reserved.  
 Eaton is a registered trademark. All other trademarks  
 are the property of their respective owners.