

# 8.6kW 208/120V Three-Phase Basic PDU - 48 Outlets (36 C13, 6 C19, 6 5-15/20R), L21-30P Input, 6 ft. Cord, 70 in. 0U Rack

MODEL NUMBER: PDU3V6L2130

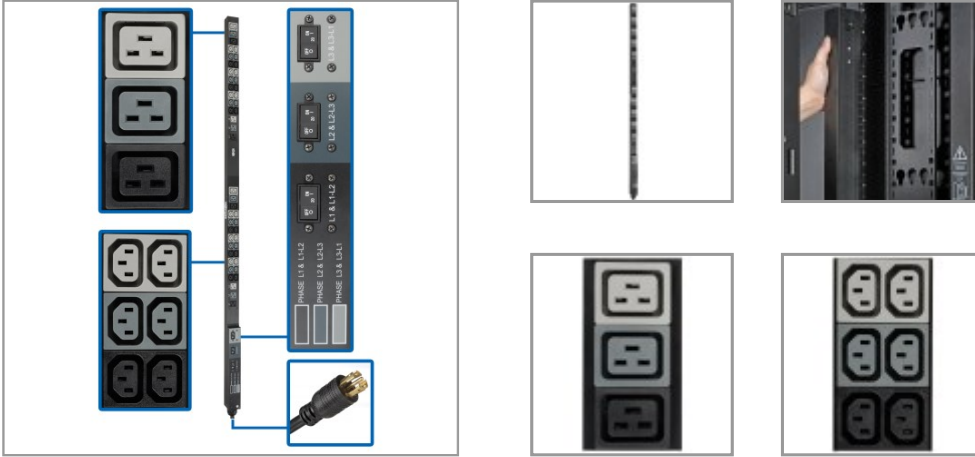

3 phase PDU Delivers 208/120V AC power to multiple loads from a utility outlet, generator or UPS system in a data center or network closet.

## Features

### Three-Phase 208/120V PDU Distributes Network-Grade Power to Multiple Loads

This basic PDU is an ideal no-frills unit for networking, telecom, security, audio/video and sound reinforcement applications. Recommended for small to mid-sized data centers, computer rooms and network closets, the PDU3V6L2130 features 36 C13 (208V), six C19 (208V) and six NEMA 5-15/20R (120V) outlets in three breakered load banks for connecting equipment. A six-foot cord with L21-30P input plug connects to your facility's AC power source, generator or protected UPS system to distribute power to connected loads.

### Up-to-Date Safety Features Protect Your Vital Equipment

The switchless design helps prevent an accidental shutdown, which could lead to costly downtime. Three 20A circuit breakers, one per output phase, protect connected components from dangerous overloads.

### Easy to Install Vertically in an EIA-Standard 19 in. Rack

The 70-inch 0U rack PDU (rPDU) all-metal housing mounts vertically using the pre-installed toolless mounting buttons or the included brackets. Spare buttons are also included. Use the included PDUMVROTATEBRKT kit to install the PDU with outlets facing the rear for better airflow or equipment access. Cable retention brackets keep power cords organized and your rack free of clutter.

### TAA-Compliant for GSA Schedule Purchases

The PDU3V6L2130 is compliant with the Federal Trade Agreements Act (TAA), which makes it eligible for GSA (General Services Administration) Schedule and other federal procurement contracts.

## Specifications

OVERVIEW	
UPC Code	037332255686
PDU Type	Basic

## Highlights

- Ideal no-frills PDU for telecom, security, audio/video and other network applications
- 36 C13, 6 C19 and 6 5-15/20R outlets distribute AC power to connected equipment
- Switchless design helps prevent accidental shutdowns that can lead to costly downtime
- 6 ft. power cord with NEMA L21-30P input connects to compatible AC source
- Compliant with the Federal Trade Agreements Act (TAA) for GSA Schedule purchases

## Package Includes

- PDU3V6L2130 8.6kW 208/120V Three-Phase Basic PDU
- Plug retention brackets with installation hardware
- Rack-mounting hardware
- Owner's manual

<b>INPUT</b>	
Input Phase	3-Phase
PDU Input Voltage	208
Recommended Electrical Service	Three-phase 30A 208V service
Maximum Input Amps	24
Maximum Input Amps Details	Agency de-rated to 24A continuous
PDU Plug Type	NEMA L21-30P
Input Cord Length (ft.)	6
Input Cord Length (m)	1.83
<b>OUTPUT</b>	
Output Capacity Details	8.6kW (208V) total capacity; 13.9A (208V) max per output phase (L1-L2, L2-L3, L3-L1) / 16A (120V) max per output phase (L1, L2, L3); 12A max per C13 outlet; 16A max per 5-20R outlet
Frequency Compatibility	50 / 60 Hz
Output Receptacle Details	5-15/20R outlets provide 120V output; C13 and C19 outlets provide 208V output
Output Receptacles	(6) 5-15/20R; (36) C13; (6) C19
Output Nominal Voltage	208/120V
Overload Protection	Three 20A double-pole circuit breakers (1 per output phase)
<b>SURGE / NOISE SUPPRESSION</b>	
Automatic Shut-Off	No
<b>PHYSICAL</b>	
Material of Construction	Metal
Rack Height	0U
Form Factors Supported	Vertical rackmount installation supported with included mounting brackets; supports toolless mounting in button-mount compatible racks
PDU Form Factor	Vertical (0U)
Shipping Dimensions (hwd / in.)	6.10 x 10.00 x 77.15
Shipping Weight (kg)	8.39
Unit Dimensions (hwd / in.)	70.000 x 2.200 x 2.650
Unit Dimensions (hwd / cm)	177.8 x 5.6 x 4.34
Unit Weight (lbs.)	13.90
Unit Weight (kg)	6.30
<b>ENVIRONMENTAL</b>	
Operating Temperature Range	32° to 104°F (0° to 40°C)
Storage Temperature Range	-22° to 140°F (-30° to 60°C)



Powering Business Worldwide



Relative Humidity	5% to 95% non-condensing
Operating Elevation	0-10000 ft. (0-3000 m)
<b>STANDARDS &amp; COMPLIANCE</b>	
Product Certifications	CAN/CSA-C22.2 No. 62368-1 (Canada); NOM (Mexico); UL 62368-1
Product Compliance	RoHS; FCC Part 15 Class A (USA); Trade Agreements Act (TAA)
<b>WARRANTY &amp; SUPPORT</b>	
Product Warranty Period (Worldwide)	2-year limited warranty

1000 Eaton Boulevard  
Cleveland, OH 44122  
United States  
<https://tripplite.eaton.com>

© 2024 Eaton. All Rights Reserved.  
Eaton is a registered trademark. All other trademarks  
are the property of their respective owners.