

PRODUCT ID: 64311

Space Available Internally Illuminated Sign

MODEL

SAI9649WGR-Q575/120VAC UC DAVIS HEALTH

DIMENSIONS

96" H x 49" W x 7.5" D (est. 187.332 lbs)

CLASS

Class: SAI Series

Control Method: Communication interface with a parking system, compatible with most major equipment providers.

CONSTRUCTION

Back Construction: 0.125" Aluminum sheet

Cabinet: Mitered extruded aluminum frame with 2 hinged faces. LED displays installed with sign-in-sign construction. Moisture absorbent interior coating

Face Material: 1/8" thick, impact modified acrylic (0000)

Faces: Single Faced Sign

Finish: Duranodic Bronze

Graphic: Printed graphic applied to surface (All graphics are printed.)

Number of Displays: (9)

ELECTRICAL

Input Voltage: 120 VAC

UL/cUL Listed: Listed for wet locations

MESSAGE

Color: Refer to message table (Gambol Gold, Invigorate, Direct Green, Kimono Violet, Blueblood, PMS 293, Black, Grey, Silver)

Display Type: Green Red 7-Seg Display

Font: Other:

Illumination: Backlit with white LEDs

Sign Messages: See message table below

MESSAGE	LED/COLOR	HEIGHT	AMPS
Roof Level 5-1 Level 00 ADA & EV Symbol SPACES	Custom Print, White Wide Angle LED	3.25", 4.75"	2.945
4-digit Seven Segment w/ FULL (8)	Green, Red Wide Angle LED	4.5"	0.133

NOTE: Above messages are independently controlled.

Product View

NOTE: Sign image may not exactly represent the finished product. For illustration purposes only.

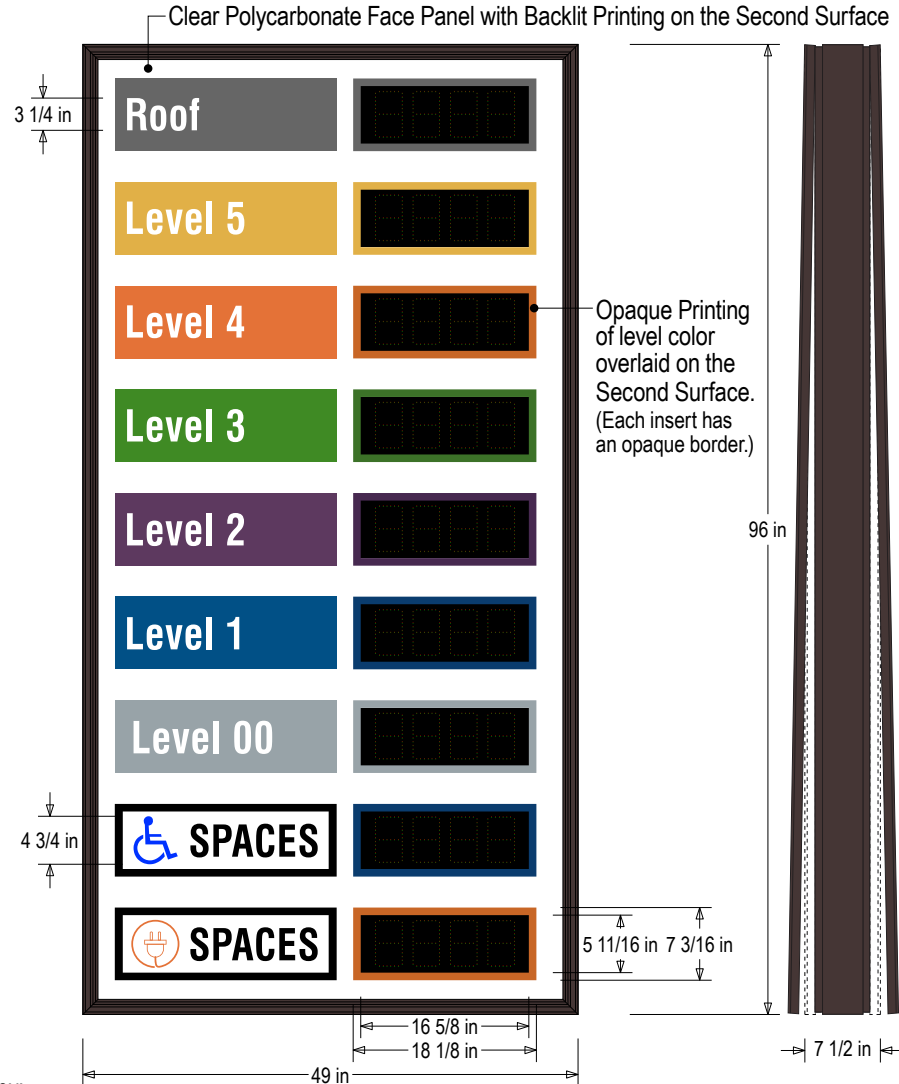

Seven Segment Display Functions:

Green

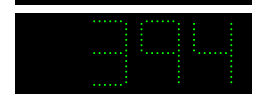
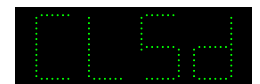
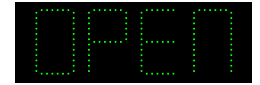

Red

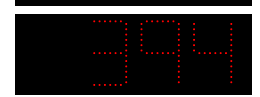

Frame Detail

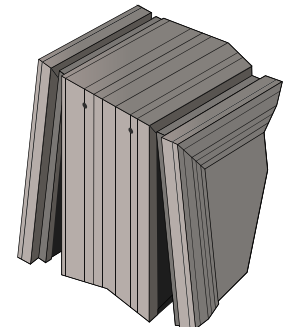

Color Key:

Printed Gambol Gold (R255 G176 B71)	Printed Kimono Violet (R93, G57, B95)	Printed Black
Printed Invigorate (R228 G114 B55)	Printed Blueblood (R1, G80, B134)	Printed Grey (R102, G102, B102)
Printed Direct Green (R63, G138, B36)	Printed PMS 293	Printed Silver (R152, G163, B168)