

RLK8-1200D4-A

12MP PoE Kit with 24/7 Full Color Images

- 12MP Ultra HD
- Person/Vehicle Detection
- 2TB HDD 8-Channel NVR

Specifications

Hardware	
Hardware	N7MB01
Video/Audio Input	
IP Video Input	Up to 12 IP cameras (max.8 wired cameras)
Audio Input	Cameras with built-in mic
Video/Audio Output	
Video Output	VGA, HDMI
Display Resolution	HDMI: 3840*2160, 1920*1080, 1280*1024, 1280*720, 1024*768 VGA: 1920*1080, 1280*1024, 1280*720, 1024*768
Audio Output	1-channel, RCA
Decoding	
Live View/Playback Resolution	7680×2160, 4608×1728, 4512×2512, 4096×3072, 3840×2160, 2560×2560, 2560×1920, 2560×1440, 2048×1536, 2304×1296, 1080p, 720p
Video Format	H.265, H.264
Synchronous Playback	Up to 4 channels

HDD	
SATA	1 x SATA interface (1 x 2TB HDD included)
Capacity	Up to 16TB (max. 8TB capacity for each HDD)
External HDD	1 eSATA interface for HDD
External Interface	
USB Interface	2 × USB 2.0
Network Interface	1, RJ-45 10/100 Mbps self-adaptive Ethernet interface for LAN/WAN 8, RJ-45 10/100 Mbps self-adaptive PoE Ethernet interface for IP camera
PoE	
Max. Power Per Port	25W
Supported Standard	IEEE 802.3 af/at
Network	
Network Protocols	HTTP, TCP/IP, UDP, DHCP, P2P, UPNP, RTSP, SMTP, SSL/TLS, DNS, DDNS, NTP, FTP
Browsers Supported	Firefox, Chrome, Edge, Safari
OS Supported	PC: Windows, Mac OS; Smartphone: iOS, Android
Max. User Access	20 users (1 admin account & 19 user accounts); up to 12 simultaneous video streams (10 substreams & 2 mainstreams)
General	
Power Supply	DC 48V~53V
Power Consumption	<10W (without HDD & PoE)
Working Environment	Temperature: -10°C~+45°C (14°F~113°F); humidity: 10%~90%
Dimensions	260 x 41 x 230mm
Weight	1.4kg

Warranty

Limited Warranty

2-year limited warranty. For support, visit <https://support.reolink.com/hc/en-us/>.

Gallery & Specs



1. Mount
2. Metal Aluminum Case
3. Spotlight
4. IR LEDs
5. High Definition Lens
6. Daylight Sensor
7. Built-in Mic
8. Speaker



Only Manual Rotation

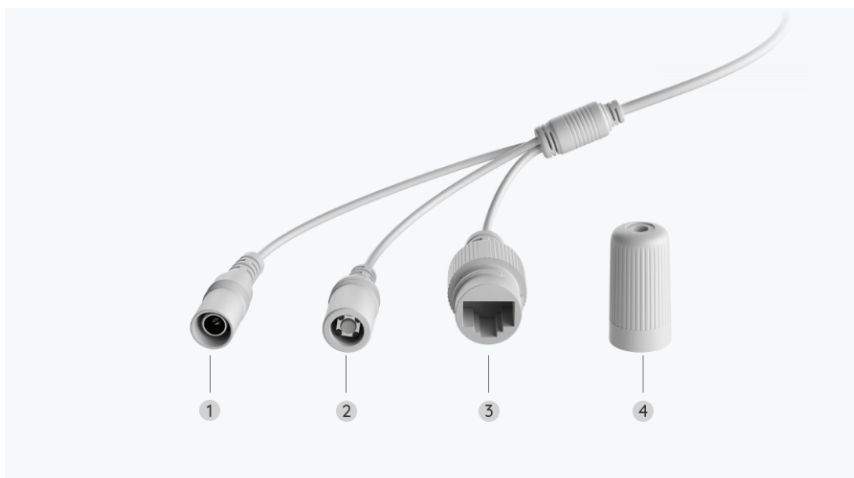

1. Power
2. Reset Button
3. Network
4. Waterproof Lid



- 1. USB Port
- 2. Power LED/HDD LED
- 3. Control Panel

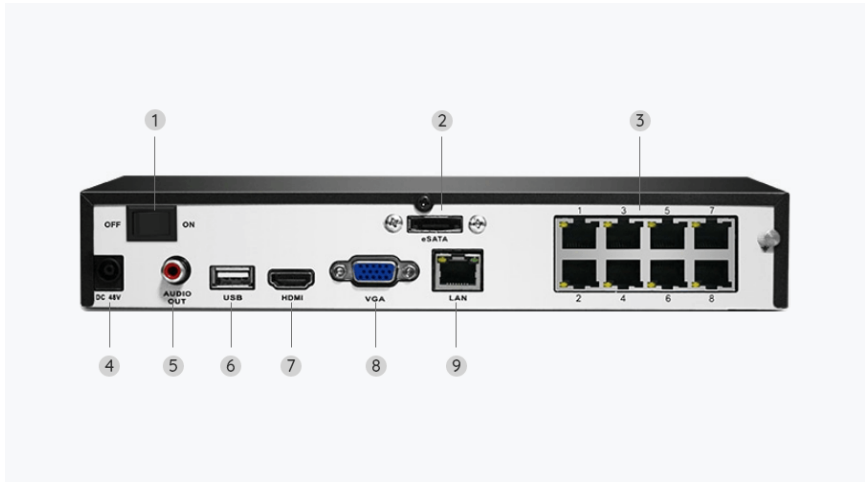

- 1. On/Off Switch
- 2. eSATA
- 3. RJ45
- 4. Power Input
- 5. Audio Out
- 6. USB Port
- 7. HDMI Port
- 8. VGA Port
- 9. Network