

Back and Lower Mount Dry Gauges



- A Durable Dry Utility Gauge for the Broad Commercial and Industrial Markets
- Suitable for Air, Water, Oil, Gas or Any Other Media Not Corrosive to Brass
- Custom Private Label Gauges Available

Applications

Pumps and Compressors
Instrument and Controls
Fluid Power Equipment

Filter Regulators and Water Pumps
Medical equipment
Air Receivers

Beverage Dispensing Systems
Automotive applications
Filters

Specifications:	PGD & VDG Series	DABS Series
Case and Bezel	<ul style="list-style-type: none"> • Black Steel Case, Chrome Plated Steel Bezel 	<ul style="list-style-type: none"> • ABS Corrosion Resistant Case with Acrylic Bezel
Dial	<ul style="list-style-type: none"> • 1-1/2", 2", 2-1/2", & 4-1/2" 	<ul style="list-style-type: none"> • 2"
Connection	<ul style="list-style-type: none"> • 1-1/2" (1/8" MNPT) 2" & Above 1/4" MNPT* 	<ul style="list-style-type: none"> • 1/4" MNPT
Lens	<ul style="list-style-type: none"> • Polycarbonate Lens 	<ul style="list-style-type: none"> • Polycarbonate Lens
Connection	<ul style="list-style-type: none"> • Back and Lower Mount 	<ul style="list-style-type: none"> • Back and Lower Mount
Bourdon Tube	<ul style="list-style-type: none"> • Copper Alloy 	<ul style="list-style-type: none"> • Copper Alloy
Pointer	<ul style="list-style-type: none"> • Black Aluminum 	<ul style="list-style-type: none"> • Black Aluminum
Socket	<ul style="list-style-type: none"> • Brass 	<ul style="list-style-type: none"> • Brass
Accuracy	<ul style="list-style-type: none"> • 3-2-3 % of Span ASME B40.1 Grade B 	<ul style="list-style-type: none"> • 3-2-3 % of Span ASME B40.1 Grade B
Ambient Temperature	<ul style="list-style-type: none"> • -50 °F to 160 °F 	<ul style="list-style-type: none"> • -50 °F to 160 °F
Scale	<ul style="list-style-type: none"> • PSI/Bar (x 100 = kPa) • Hg/Bar (x 100 = kPa) 	<ul style="list-style-type: none"> • PSI/Bar (x 100 = kPa) • Hg/Bar (x 100 = kPa)
Features	<ul style="list-style-type: none"> • Individually Boxed • Design Meets or Exceeds ASME B40.100 • Built-In Snubber 	<ul style="list-style-type: none"> • Individually Boxed • Design Meets or Exceeds ASME B40.100 • Built-In Snubber

* Select 2" gauges are available with 1/8" MNPT connection

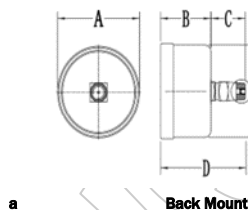

Back Mount

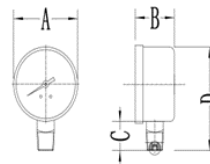

Lower Mount

Back Mount Gauges

Dial Size	PGDB Pressure Gauges	VGDB Vacuum Gauges	DABS -B Pressure Gauges	Connection	A (In)	B (In)	C (In)	D (In)	E (In)	Wt. (lbs.)
1-1/2"	PGDB15	VGDB15-030	—	1/8"	1.65	.98	.65	1.63	1.59	.14
2"	PGDB20	—	—	1/8"	2.09	1.04	.73	1.77	2.01	.15
2"	PGDB20	VGDB20-030	—	1/4"	2.09	1.04	.73	1.77	2.01	.15
2"	—	—	DABS-B20	1/4"	2.09	1.03	.70	1.73	2.09	.12
2-1/2"	PGDB25	VGDB25-030	—	1/4"	2.36	1.07	.73	1.80	2.32	.21
4-1/2"	PGDB45	—	—	1/4"	4.57	1.18	.67	1.85	4.49	.32

Lower Mount Gauges

Dial Size	PGDL Pressure Gauges	VGDL Vacuum Gauges	DABS -L Pressure Gauges	Connection	A (In)	B (In)	C (In)	D (In)	Wt. (lbs.)
1-1/2"	PGDL15	VGDL15-030	—	1/8"	1.65	.98	.67	2.25	.14
2"	—	VGDL208-030	—	1/8"	2.09	1.04	.81	2.85	.15
2"	PGDL20	VGDL20-030	—	1/4"	2.09	1.04	.81	2.85	.15
2"	—	—	DABS-L20	1/4"	2.09	1.03	.83	2.91	.14
2-1/2"	PGDL25	VGDL25-030	—	1/4"	2.36	1.12	.81	3.13	.21
4-1/2"	PGDL45	VGDL45-030	—	1/4"	4.57	1.18	1.01	5.50	.32



WARNING: This product can expose you to chemicals, including lead, which is known to the State of California to cause cancer and reproductive harm. For more information go to

Ordering and Technical Information

Back and Lower Mount Dry Pressure Gauges

Part No.	PGDB15-X Back Mount	PGDL15-X Lower Mount	PGDB208-X Back Mount	PGDB20-X Back Mount	PGDL20-X Lower Mount	DABS-B20-X Back Mount	DABS-L20-X Lower Mount	PGDB25-X Back Mount	PGDL25-X Lower Mount	PGDB45-X Back Mount	PGDL45-X Lower Mount
Dial Size	1-1/2"	1-1/2"	2"	2"	2"	2"	2"	2-1/2"	2-1/2"	4-1/2"	4-1/2"
Connection Size	1/8"	1/8"	1/8"	1/4"	1/4"	1/4"	1/4"	1/4"	1/4"	1/4"	1/4"
PSI Code											
15	X	—	—	X	X	—	—	—	—	—	X
30	X	X	—	X	X	—	—	X	—	X	—
60	X	X	—	X	X	—	—	X	—	—	—
100	X	X	—	X	X	—	—	X	X	—	—
160	X	X	X	X	X	X	X	X	X	—	X
200	X	X	X	X	X	X	X	X	X	X	X
300	X	X	—	X	X	X	X	X	X	X	X

1. Select the gauge configuration required
2. Add the psi to the part number suffix, replacing the X
2. Confirm gauge series and psi availability on chart

Back and Lower Mount Dry Vacuum Gauges

Part No.	VGDB15-030 Back Mount	VGDL15-030 Lower Mount	VGDB20-030 Back Mount	VGDL20-030 Lower Mount	VGDL20-030 Lower Mount	VGDB25-030 Back Mount	VGDL25-030 Lower Mount	VGDL45-030 Lower Mount
Dial Size	1-1/2"	1-1/2"	2"	2"	2"	2-1/2"	2-1/2"	4-1/2"
Connection Size	1/8"	1/8"	1/4"	1/8"	1/4"	1/4"	1/4"	1/4"
PSI Code								
-30/0	X	X	X	X	X	X	X	X

Notes
PGDB, PGDL, VGDB and VGDL series include black steel case and chrome plated steel bezel
DABS-B and DABS-L series include ABS corrosion resistant case and acrylic bezel

Vacuum Gauges

Range	Major Increments	Minor Increments
30/0"VAC	5" hg	.5" hg

Pressure Gauges

Range	Major Increments	Minor Increments
0/15	2 psi	.1 psi
0/30	5 psi	.5 psi
0/60	10 psi	1 psi
0/100	20 psi	2 psi
0/160	20 psi	2 psi
0/200	40 psi	5 psi
0/300	50 psi	5 psi