

Y-1 SELF CLOSING SERIES

FROST PROOF YARD HYDRANT FEATURES/BENEFITS

Several important improvements have been made on the self-closing hydrant over the years. These improvements and the basic design are why we believe the self-closing is the best hydrant of its type in the industry.

- * (1) **SELF-CLOSING** Stainless steel spring and water pressure closes hydrant.
BENEFIT: Hydrant shuts off so water is not wasted. Ideal for public use.
- (2) **LOCKS OPEN OR CLOSED** Simply push lock button to lock hydrant open or closed. (Available WITHOUT locking pin - so only open when the hydrant head is manually pushed down.)
BENEFIT: Hydrant can be locked to restrict use if needed.
- (3) **BRASS OR NO-LEAD BRASS HOSE ADAPTER** Heavy-duty hose adapter for standard 3/4" hose coupling.
BENEFIT: Standard garden hose thread in long life non-corrosive brass or no-lead brass.
- (4) **EXTRA THICK WALLED HEAD CASTING** greatly reduces breakage and insures longer life.
BENEFIT: Withstands years of use and rough service.
- * (5) **FLOW CONTROL VALVE AVAILABLE** Standard hydrant sold without flow control valve, if wanted order separately. To install simply remove top plug.
BENEFIT: Flow rate can be regulated easily.
- (6) **CAP SCREWS** Hydrants manufactured after 11/1/77 will have 3/8" x 5/16" self-locking socket head cap screws, and assembled with a locking sealant.
BENEFIT: Provides strong hold for hydrant head to pipe for years of service.
- (7) **HIGH QUALITY GALVANIZED PIPE** 1" extra heavy pipe on outside and galvanized pipe on inside.
BENEFIT: Corrosion protected for long life.
- (8) **NO EXPOSED THREADS** on inside pipe or outside pipe.
BENEFIT: No uncoated metal to rust for longest life.
- * (9) **CAST IRON BODY WITH STAINLESS STEEL SLEEVE** for plunger seals to travel in, and pressed into heavy cast iron valve body for strength and economy.
BENEFIT: Economical smoother sealing surface for plunger seals.
- * (10) **SOLID BRASS PLUNGER** Hydrants manufactured after 11/1/78 will have (3) ethylene propylene quad ring seals, self-lubricating and never come out of adjustment, have longer life, and withstand higher pressures.
BENEFIT: Longest operating life plunger of its type.
- * (11) **SWIVEL PARTS** permit withdrawal of all moving parts without digging up hydrant. A 3/16" Hex Key will allow disassembly of hydrant by simply removing two cap screws and pull up inside pipe with plunger for inspection.
BENEFIT: Very easy to repair, simple reliable design.

*EXCLUSIVE MERRILL QUALITY FEATURES

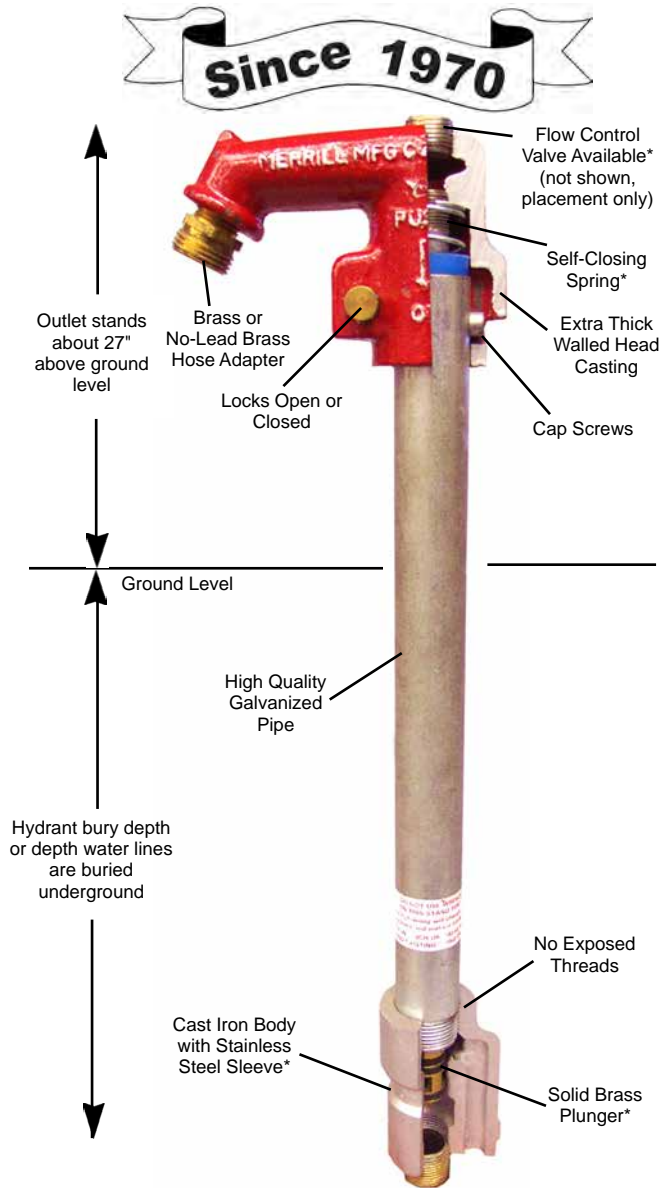

Y-1 FLOW RATES

WATER SYSTEM PRESSURE	STD. 3/4" GALLONS PER MINUTE (GPM)										
	0	5	10	15	20	25	30	35	40	45	50
20 PSI	13.6 GPM @ 20 PSI										
30 PSI	15.2 GPM @ 30 PSI										
40 PSI	18.8 GPM @ 40 PSI										
60 PSI	23 GPM @ 60 PSI										

Recommended Maximum Operating Pressure 60 psi
(Due to Self-Closing Design)
Most common submersible pump 1/2 hp, output 10 GPM.
Flow Control Valve Available.



Y-2 SELF CLOSING SERIES

FROST PROOF YARD HYDRANT FEATURES/BENEFITS

Several important improvements have been made on the self-closing hydrant over the years. These improvements and the basic design are why we believe the self-closing is the best hydrant of its type in the industry.

- * (1) **SELF-CLOSING** Stainless steel spring and water pressure closes hydrant.
BENEFIT: Hydrant shuts off so water is not wasted. Ideal for public use.
- (2) **LOCKS OPEN OR CLOSED** Simply push lock button to lock hydrant open or closed.
BENEFIT: Hydrant can be locked to restrict use if needed.
- (3) **BRASS OR NO-LEAD BRASS HOSE ADAPTER** Heavy-duty hose adapter for standard 3/4" hose coupling. Interchangeable with head plug for easier plumbing attachment when needed.
BENEFIT: Standard garden hose thread in long life non-corrosive brass or no-lead brass.
- (4) **EXTRA THICK WALLED HEAD CASTING** greatly reduces breakage and insures longer life.
BENEFIT: Withstands years of use and rough service.
- * (5) **HEAD PLUG** can be installed in front of head casting simply by changing places with hose adapter.
BENEFIT: Provides easier plumbing attachment when needed.
- (6) **CAP SCREWS** Hydrants manufactured after 11/1/77 will have 3/8" x 5/16" self-locking socket head cap screws, and assembled with a locking sealant.
BENEFIT: Provides strong hold for hydrant head to pipe for years of service.
- (7) **HIGH QUALITY GALVANIZED PIPE** 1" extra heavy pipe on outside and galvanized pipe on inside.
BENEFIT: Corrosion protected for long life.
- (8) **NO EXPOSED THREADS** on inside pipe or outside pipe.
BENEFIT: No uncoated metal to rust for longest life.
- * (9) **CAST IRON BODY WITH STAINLESS STEEL SLEEVE** for plunger seals to travel in and pressed into heavy cast iron valve body for strength and economy.
BENEFIT: Economical, smoother sealing surface for plunger seals.
- * (10) **SOLID BRASS PLUNGER** Hydrants manufactured after 11/1/78 will have (3) ethylene propylene quad ring seals, self-lubricating and never come out of adjustment, have longer life and withstand higher pressures.
BENEFIT: Longest operating life plunger of its type.
- * (11) **SWIVEL PARTS** permit withdrawal of all moving parts without digging up hydrant. A 3/16" Hex Key will allow disassembly of hydrant by simply removing two cap screws and pull up inside pipe with plunger for inspection.
BENEFIT: Very easy to repair, simple reliable design.

***EXCLUSIVE MERRILL QUALITY FEATURES**

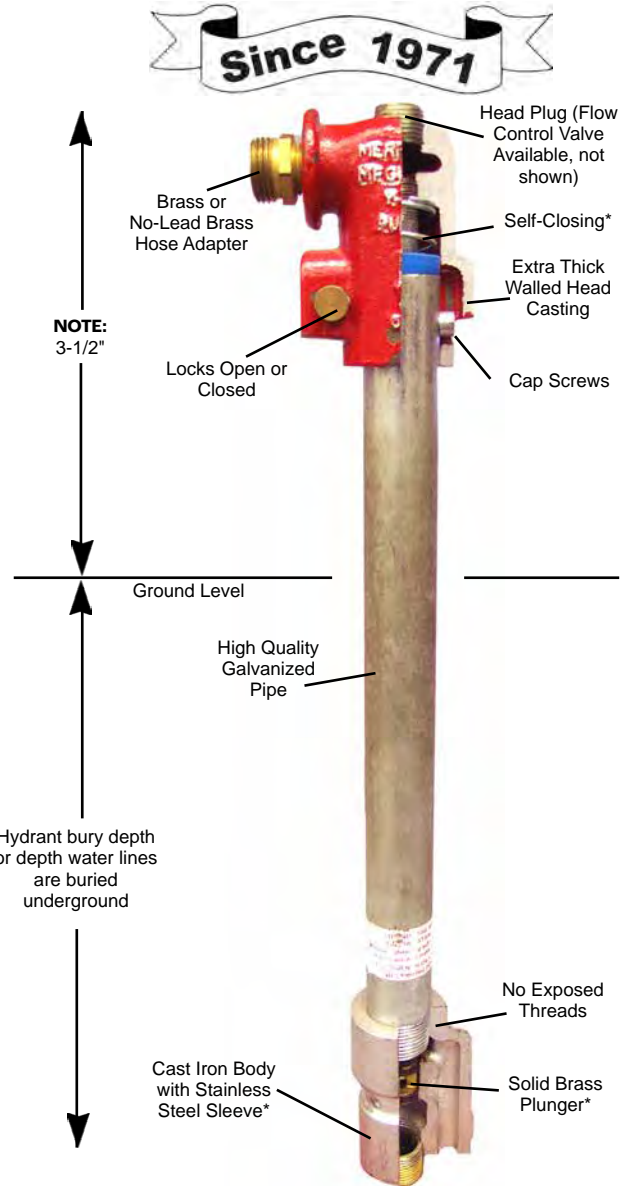

NOTE:
3-1/2"

Y-2 FLOW RATES

WATER SYSTEM PRESSURE	STD. 3/4" GALLONS PER MINUTE (GPM)									
	0	5	10	15	20	25	30	35	40	45
20 PSI	13.6 GPM @ 20 PSI									
30 PSI	15.2 GPM @ 30 PSI									
40 PSI	18.8 GPM @ 40 PSI									
60 PSI	23 GPM @ 60 PSI									

Recommended Maximum Operating Pressure 60 psi
(Due to Self-Closing Design)
Most common submersible pump 1/2 hp, output 10 GPM.
Flow Control Valve Available.



Lead



MERRILL MANUFACTURING



No-Lead CA. Certified

Y-1 AND Y-2 SELF CLOSING PARTS

Y-1 Specifications

Inlet: 3/4" NPT Outlet: 3/4" Brass or No-Lead Brass Hose Thread
Self-Closing can be locked open or closed
Brass Plunger with three quad ring seals
1" Galvanized Pipe & Galvanized Internal Pipe
Outlet stands 27" above ground level

Y-1 SELF CLOSING - STANDARD 3/4" INLET

Order No.	UPC Bar Code (Qty. 1)	Inlet x Length	Overall Length	Approx. Wt./Lbs.
Y17501	6 42367 03038 4	3/4" x 1' Bury	40.3"	13.16
Y17502	6 42367 03039 1	3/4" x 2' Bury	52.3"	15.70
Y17503	6 42367 03040 7	3/4" x 3' Bury	64.3"	18.24
Y17504	6 42367 03041 4	3/4" x 4' Bury	76.3"	20.78
Y17505	6 42367 03042 1	3/4" x 5' Bury	88.3"	23.32
Y17506	6 42367 03043 8	3/4" x 6' Bury	100.3"	25.86
Y17507	6 42367 03044 5	3/4" x 7' Bury	112.3"	28.40
Y17508	6 42367 03045 2	3/4" x 8' Bury	124.3"	30.94
Y17510	6 42367 03046 9	3/4" x 10' Bury	148.3"	33.48

Y-2 Specifications

Inlet: 3/4" NPT Outlet: 3/4" Brass or No-Lead Brass Hose Thread
Self-Closing can be locked open or closed
Brass Plunger with three quad ring seals
1" Galvanized Pipe & Galvanized Internal Pipe
Outlet stands 3-1/2" above ground level

Y-2 SELF-CLOSING STANDARD 3/4" INLET

Order No.	UPC Bar Code (Qty. 1)	Inlet Size x Length	Overall Length	Approx. Wt./Lbs.
Y27502	6 42367 03054 4	3/4" x 2' Bury	29"	10.10
Y27503	6 42367 03055 1	3/4" x 3' Bury	41"	12.64
Y27504	6 42367 03056 8	3/4" x 4' Bury	53"	15.18
Y27505	6 42367 03057 5	3/4" x 5' Bury	65"	17.72
Y27506	6 42367 03058 2	3/4" x 6' Bury	77"	20.26
Y27507	6 42367 03059 9	3/4" x 7' Bury	89"	22.80
Y27508	6 42367 03060 5	3/4" x 8' Bury	101"	25.34
Y27510	6 42367 03061 2	3/4" x 10' Bury	125"	27.88

Y-1 AND Y-2 PARTS LIST

Order No.	UPC Bar Code (Qty. 1)	Parts Description
Y-1	6 42367 03035 3	Head Complete-Part No. Y-2A, Y-4, G-6, 1/8x3/8MDK
Y-2	6 42367 03052 0	Head Complete-Part No. Y-2A, Y-4, G-6, 1/8x3/8MDK
Y-2A	6 42367 03062 9	Lock Pin
1/8x3/8MDK	6 42367 00051 6	Roll Pin
Y-3	6 42367 03068 1	Compression Spring
TECTM125ACUT	6 42367 10014 8	Spring Retainer
Y-4	6 42367 03089 6	Countersunk Head Plug
G-6	6 42367 01543 5	Brass Hose Thread Adapter
GNL-6	6 42367 41048 3	No-Lead Hose Thread Adapter
Y-7		1/4" x 1/4" Socket Head Cap Screw (no longer available) (used before 11/1/77)
Y-8	6 42367 03100 8	3/8" x 5/16" Self-Locking Socket Head Cap Screw (used after 11/1/77)
Y-20	6 42367 03053 7	Flow Control Valve (Optional)
Y-35		3/8" Galvanized Pipe
Y-37		1" Galvanized Pipe
Y-40	6 42367 03090 2	Valve Body with Stainless Steel Insert
Y-41B	6 42367 03096 4	Plunger with Seals
Y-45X	6 42367 03098 8	Quad Ring Seals (used after 11/1/78)
A-250	6 42367 07720 4	Container of Silicone Lube

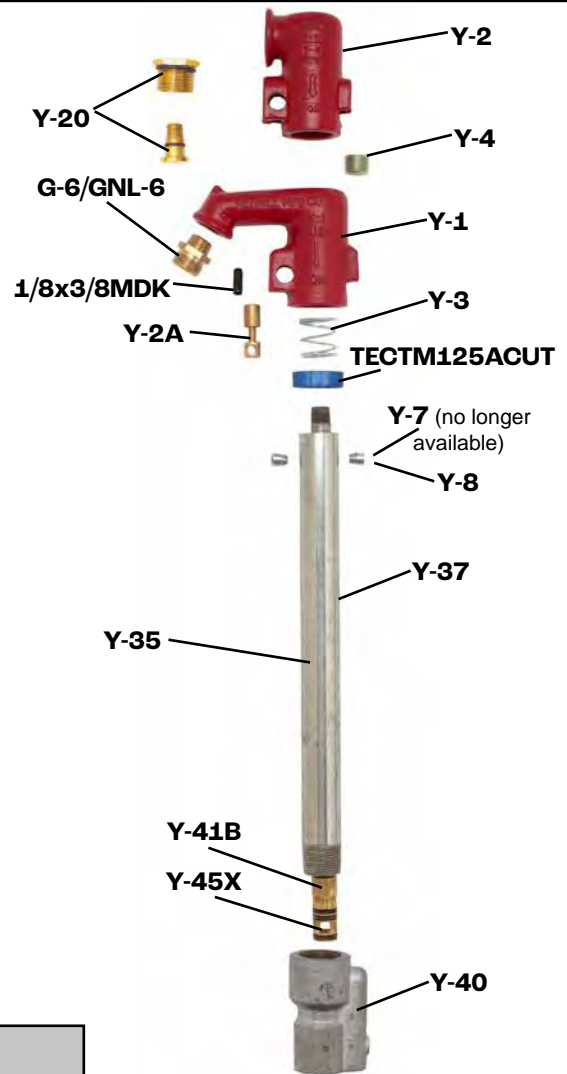

HYDRANTS AVAILABLE WITH OPTIONAL No-Lead Brass Vacuum Breakers

- VBADNL75 3/4" Hose - Brass Finish - AUTO DRAIN - No-Lead
- BVBNL75M 3/4" Hose - Brass Finish - MANUAL DRAIN - No-Lead



WARNING: This product can expose you to lead, which is known to the State of California to cause cancer, birth defects or other reproductive harm. (For more information go to www.p65warnings.ca.gov)

WARNING: This product meets Federal USA Drinking Water requirements but has not been specifically tested or approved as no-lead in the State of California.