



E-5000 SERIES

"The Best of Both Worlds-Quality and Price"

FROST PROOF YARD HYDRANT

FEATURES/BENEFITS

- * (1) **ALL-WEATHER POWDER-COAT FINISH LEVER CONTROL** operates by cam principle and pulls straight up on operating rod. Provides variable flow from trickle to full flow without lock to hold lever.
BENEFIT: Variable flow with no lock that rusts in place.
- (2) **DRAW STRAPS** are made of 1040 hot rolled steel which is much harder (Brinell 175/200) and stronger. Greatly reduces wear of straps and eliminates side pull on operating rod.
BENEFIT: Longest operating life.
- (3) **OPERATING ROD** has smooth galvanized surface for maximum packing life.
BENEFIT: Longer service life of seal around rod.
- (4) **HEAVY-DUTY SOLID BRASS OR NO-LEAD BRASS HOSE ADAPTER** threaded for standard 3/4" hose coupling.
BENEFIT: Standard hose fitting readily available.
- (5) **ALL-WEATHER POWDER-COAT FINISH HEAVY CAST IRON HEAD** with the same design Merrill has used for over seventy-five years.
BENEFIT: Time-proven design takes years of abuse.
- * (6) **PIVOT CONNECTOR** a 1/4" hex head bolt provides simple positive adjustment and eliminates unreliable set screw used by other companies.
BENEFIT: Adjustable for years, not like rusting set screw.
- (7) **TOUGH PACKING GLAND** for easy plunger removal.
BENEFIT: Less time for plunger replacement.
Option: Metal packing gland available in EM-Series.
- (8) **NO-LEAD GALVANIZED PIPE** has no exposed threads subject to the weather.
BENEFIT: No exposed steel on pipe to rust.
- (9) **ONE PIECE PLUNGER** uses double seal design to assure positive shut-off even when foreign particles are present. Plunger positively opens drain to prevent freezing, and positively closes even at slow flow rates.
BENEFIT: Economical design that still closes drain hole.
- * (10) **LONG LIFE PLUNGER** is molded with ethylene propylene material that is self-lubricating and will not bond to brass or no-lead brass valve body like rubber plunger used by other companies.
BENEFIT: Longest operating life in one piece design.
- (11) **DOUBLE BYPASS VALVE BODY** provides a large volume of water and the time-proven design used for over seventy years.
BENEFIT: High water flow with economical design.
- (12) **LOCKING EYE** on head and lever allows hydrant to be padlocked shut when not in use.
BENEFIT: Protects from waste of water.
- * (13) **SIMPLEST HYDRANT TO SERVICE** no need to dig up hydrant to inspect plunger. Shut off water supply. Remove lever handle, loosen packing gland in head casting and pull up rod with plunger, or simply unscrew head and pull out rod and plunger.
BENEFIT: Very simple repair, easily done at ground level.

* EXCLUSIVE MERRILL QUALITY FEATURES

NOTE: If hydrant is to be used in a high pressure application, please contact the factory.



Merrill E-5000 Series Yard Hydrant

Gives year 'round Water Service,
Drains Below Frost Line When Shut Off, and
features a Powder Coated Head which
enhances resistance to corrosion,
UV and abrasion.

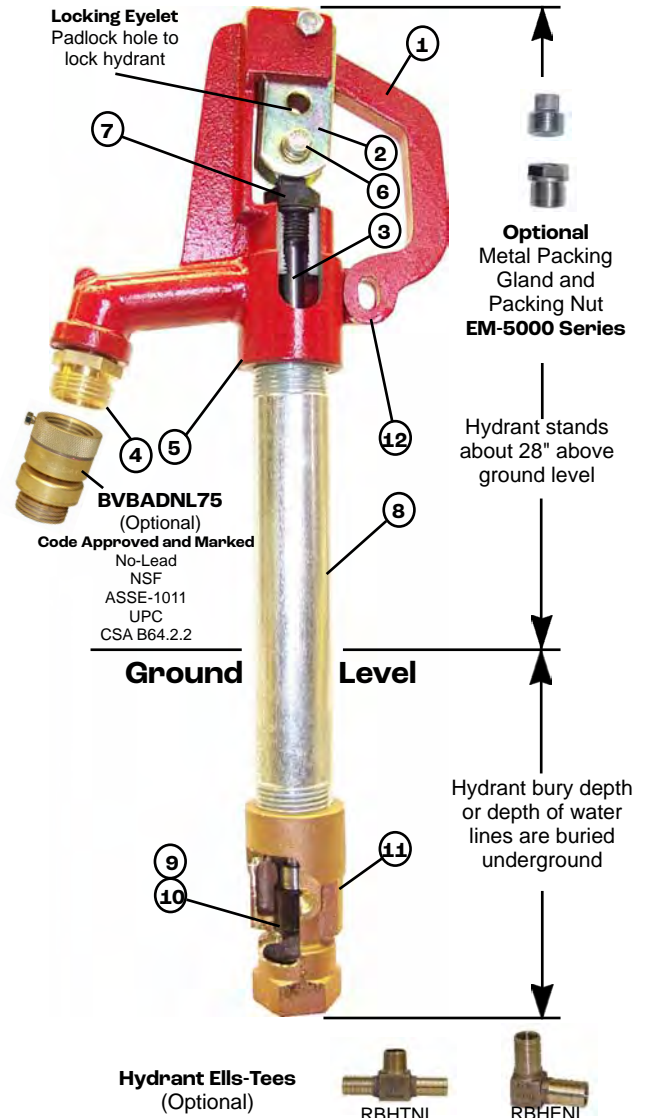

Merrill E7504 or 4' Bury Hydrant is about
6'-3-1/2" long, 4' is buried and 28" above ground.

SPECIFICATIONS

E-5000/ENL-5000 Series

Inlet - 3/4" NPT in Casting Graphite Packing
Outlet - 3/4" Hose Thread Adapter 1" Galvanized Pipe
Brass or No-Lead Brass and Molded Rubber Plunger made of
self-lubricating material



No-Lead

Lead



MERRILL
MANUFACTURING

1

E-5000/ENL-5000 & EM-5000/EMNL-5000 SERIES

E-5000 and
ENL-5000
Series



EM-5000 and
EMNL-5000
Series



E-5000 HYDRANTS

Order No.	UPC Bar Code (Qty. 1)	Pipe Connection x Pipe Depth	Pipe Size	Overall Length	Approx. Wt./Lbs.
E7501	6 42367 05423 6	3/4" x 1' Bury	1" Galv.	39.5"	9.5
E75015	6 42367 05424 3	3/4" x 1-1/2' Bury	1" Galv.	45.5"	10.5
E7502	6 42367 05425 0	3/4" x 2' Bury	1" Galv.	51.5"	11.5
E7503	6 42367 05426 7	3/4" x 3' Bury	1" Galv.	63.5"	12.5
E7504	6 42367 05427 4	3/4" x 4' Bury	1" Galv.	75.5"	13.5
E7505	6 42367 05428 1	3/4" x 5' Bury	1" Galv.	87.5"	14.5
E7506	6 42367 05429 8	3/4" x 6' Bury	1" Galv.	99.5"	15.5
E7507	6 42367 05430 4	3/4" x 7' Bury	1" Galv.	111.5"	16.5
E7508	6 42367 05431 1	3/4" x 8' Bury	1" Galv.	123.5"	17.5
E7510	6 42367 05432 8	3/4" x 10' Bury	1" Galv.	147.5"	19.5

NOTE: The length of hydrant you need depends on the depth the water lines are buried in your area. If water lines are buried 4' you need the E7504 - 4' bury below ground with 28" above ground or 6'-3-1/2" total length.

ENL-5000 NO-LEAD HYDRANTS

Order No.	UPC Bar Code (Qty. 1)	Pipe Connection x Pipe Depth	Pipe Size	Overall Length	Approx. Wt./Lbs.
ENL7501	6 42367 41824 3	3/4" x 1' Bury	1" Galv.	39.5"	9.5
ENL7502	6 42367 41825 0	3/4" x 2' Bury	1" Galv.	51.5"	11.5
ENL7503	6 42367 41826 7	3/4" x 3' Bury	1" Galv.	63.5"	12.5
ENL7504	6 42367 41827 4	3/4" x 4' Bury	1" Galv.	75.5"	13.5
ENL7505	6 42367 41828 1	3/4" x 5' Bury	1" Galv.	87.5"	14.5
ENL7506	6 42367 41829 8	3/4" x 6' Bury	1" Galv.	99.5"	15.5
ENL7507	6 42367 41830 4	3/4" x 7' Bury	1" Galv.	111.5"	16.5
ENL7508	6 42367 41831 1	3/4" x 8' Bury	1" Galv.	123.5"	17.5
ENL7510	6 42367 41833 5	3/4" x 10' Bury	1" Galv.	147.5"	19.5

NOTE: The length of hydrant you need depends on the depth the water lines are buried in your area. If water lines are buried 4' you need the ENL7504 - 4' bury below ground with 28" above ground or 6'-3-1/2" total length.

EM-5000 HYDRANTS *

Order No.	UPC Bar Code (Qty. 1)	Pipe Connection x Pipe Depth	Pipe Size	Overall Length	Approx. Wt./Lbs.
EM7501	6 42367 11794 8	3/4" x 1' Bury	1" Galv.	39.5"	9.5
EM75015	6 42367 11795 5	3/4" x 1-1/2' Bury	1" Galv.	45.5"	10.5
EM7502	6 42367 11796 2	3/4" x 2' Bury	1" Galv.	51.5"	11.5
EM7503	6 42367 11797 9	3/4" x 3' Bury	1" Galv.	63.5"	12.5
EM7504	6 42367 11798 6	3/4" x 4' Bury	1" Galv.	75.5"	13.5
EM7505	6 42367 11799 3	3/4" x 5' Bury	1" Galv.	87.5"	14.5
EM7506	6 42367 11800 6	3/4" x 6' Bury	1" Galv.	99.5"	15.5
EM7507	6 42367 11801 3	3/4" x 7' Bury	1" Galv.	111.5"	16.5
EM7508	6 42367 11802 0	3/4" x 8' Bury	1" Galv.	123.5"	17.5
EM7510	6 42367 11803 7	3/4" x 10' Bury	1" Galv.	147.5"	19.5

* with metal packing gland

EMNL-5000 NO-LEAD HYDRANTS *

Order No.	UPC Bar Code (Qty. 1)	Pipe Connection x Pipe Depth	Pipe Size	Overall Length	Approx. Wt./Lbs.
EMNL7501	6 42367 41834 2	3/4" x 1' Bury	1" Galv.	39.5"	9.5
EMNL75015	6 42367 42774 0	3/4" x 1-1/2' Bury	1" Galv.	45.5"	10.5
EMNL7502	6 42367 41835 9	3/4" x 2' Bury	1" Galv.	51.5"	11.5
EMNL7503	6 42367 41836 6	3/4" x 3' Bury	1" Galv.	63.5"	12.5
EMNL7504	6 42367 41837 3	3/4" x 4' Bury	1" Galv.	75.5"	13.5
EMNL7505	6 42367 41838 0	3/4" x 5' Bury	1" Galv.	87.5"	14.5
EMNL7506	6 42367 41839 7	3/4" x 6' Bury	1" Galv.	99.5"	15.5
EMNL7507	6 42367 41840 3	3/4" x 7' Bury	1" Galv.	111.5"	16.5
EMNL7508	6 42367 41841 0	3/4" x 8' Bury	1" Galv.	123.5"	17.5
EMNL7510	6 42367 41842 7	3/4" x 10' Bury	1" Galv.	147.5"	19.5

* with metal packing gland

E-5000 Hydrant Flow Rates

WATER SYSTEM PRESSURE	GALLONS PER MINUTE (GPM)										
	0	5	10	15	20	25	30	35	40	45	50
20 PSI	15.4 GPM @ 20 PSI										
30 PSI	18 GPM @ 30 PSI										
40 PSI	22 GPM @ 40 PSI										
60 PSI	27 GPM @ 60 PSI										
80 PSI	32 GPM @ 80 PSI										
100 PSI	36 GPM @ 100 PSI										
NOTE: Most common 1/2 hp submersible pumps output is 10 GPM.											



WARNING: This product can expose you to lead, which is known to the State of California to cause cancer, birth defects or other reproductive harm. (For more information go to www.p65warnings.ca.gov)



WARNING: This product meets Federal USA Drinking Water requirements but has not been specifically tested or approved as no-lead in the State of California.

1

Lead

**MERRILL**
MANUFACTURING

No-Lead ❖ CA. Certified

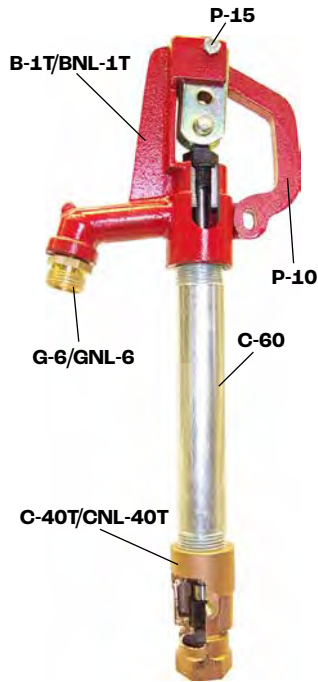
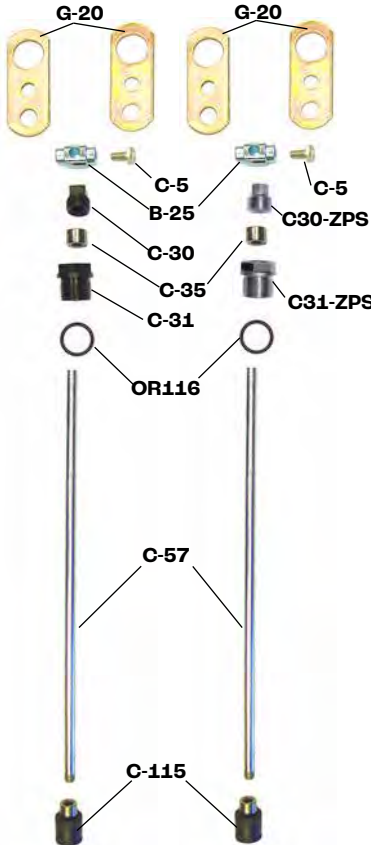
E-5000 PARTS**PARTS LIST****E-5000 & ENL-5000****EM-5000 & EMNL-5000****PARTS KIT "E"**

Qty.	Part No.
4	C-5
3 Pr.	G-20
2	B-25
3	C-30
3	C-31
3	OR116
3	C-35
3	C-115

ORDER NO. PKEUPC Bar Code (Qty. 1)
6 42367 06111 1**PARTS KIT "EM"**

Qty.	Part No.
4	C-5
3 Pr.	G-20
2	B-25
3	C30-ZPS
3	C31-ZPS
3	OR116
3	C-35
3	C-115

ORDER NO. PKEMUPC Bar Code (Qty. 1)
6 42367 11804 4

Hydrants available with optional No-Lead Bronze
Hydrant Ells/Tees. Include number (i.e. **RBHENL100**)
 after Order No.

No-Lead Bronze Hydrant Ells/Tees

RBHENL75, RBHENL100, RBHTNL75, RBHTNL7510



Hydrants available with optional No-Lead Vacuum Breakers
BVBADNL75 and BVBNL75M

BVBADNL75Code Approved and Marked
No-Lead
NSF
ASSE-1011
UPC
CSA B64.2.2**BVBNL75M**Code Approved and Marked
No-Lead
ASSE-1011
UPC
CSA B64.2.2**PARTS LIST**

Part No.	UPC Bar Code (Qty. 1)	Part Description
B-1T	6 42367 05480 9	Head Casting (Includes G-6)
BNL-1T	6 42367 42437 4	No-Lead Head Casting (Includes GNL-6)
C-5	6 42367 03308 8	Stainless Steel 1/4" Hex Head Bolt
G-6	6 42367 01543 5	Hose Thread Adapter
GNL-6	6 42367 41048 3	No-Lead Hose Thread Adapter
P-10	6 42367 01979 2	Lever Casting
P-15	6 42367 01985 3	Lever Bolt & Nut
G-20	6 42367 01514 5	Draw Straps (Per Pr.)
B-25	6 42367 57695 2	Pivot Connector
C-30	6 42367 05369 7	Packing Nut
C-31	6 42367 05370 3	Packing Gland
C30-ZPS	6 42367 11741 2	Metal Packing Nut
C31-ZPS	6 42367 11740 5	Metal Packing Gland
C-35	6 42367 05476 2	Valve Stem Packing
OR116	6 42367 05481 6	O-Ring Seal
C-40T	6 42367 10044 5	Valve Body
CNL-40T	6 42367 41695 9	No-Lead Valve Body
C-57		5/16" Operating Rod
C-60		1" No-Lead Galvanized Pipe
C-115	6 42367 00974 8	Plunger
B-121	6 42367 05484 7	Head Assembly Parts No. B-1T, B-25, C-5, C-30, C-31, C-35, G-6, G-20, OR116, P-10 & P-15
BNL-121	6 42367 42438 1	No-Lead Head Assembly Parts No. BNL-1T, B-25, C-5, C-30, C-31, C-35, GNL-6, G-20, OR116, P-10 & P-15
BM-121	6 42367 42360 5	Head Assembly Parts No. B-1T, B-25, C-5, C30-ZPS, C31-ZPS, C-35, G-6, G-20, OR116, P-10 & P-15
BMNL-121	6 42367 42439 8	No-Lead Head Assembly Parts No. BNL-1T, B-25, C-5, C30-ZPS, C31-ZPS, C-35, GNL-6, G-20, OR116, P-10 & P-15
C-131	6 42367 09912 1	Packing Gland Assembly C-30, C-31, C-35, OR116
C131-ZPS	6 42367 11777 1	Packing Gland Assembly C30-ZPS, C31-ZPS, C-35, OR116
A-250	6 42367 07720 4	Container of Silicone Lube

PARTS KIT "EF"

Qty.	Part No.
1	C-5
1 Pr.	G-20
1	B-25
1	C-30
1	C-31
1	OR116
1	C-35
1	C-115

ORDER NO. PKEFUPC Bar Code (Qty. 1)
6 42367 05793 0**PARTS KIT "EFM"**

Qty.	Part No.
1	C-5
1 Pr.	G-20
1	B-25
1	C30-ZPS
1	C31-ZPS
1	OR116
1	C-35
1	C-115

ORDER NO. PKEFMUPC Bar Code (Qty. 1)
6 42367 11805 1**PARTS KIT "EP"**

Qty.	Part No.
1	C-35
1	C-115
1	A-250

ORDER NO. PKEPUPC Bar Code (Qty. 1)
6 42367 07721 1

WARNING: This product can expose you to lead, which is known to the State of California to cause cancer, birth defects or other reproductive harm. (For more information go to www.p65warnings.ca.gov)



WARNING: This product meets Federal USA Drinking Water requirements but has not been specifically tested or approved as no-lead in the State of California.