

IM512A

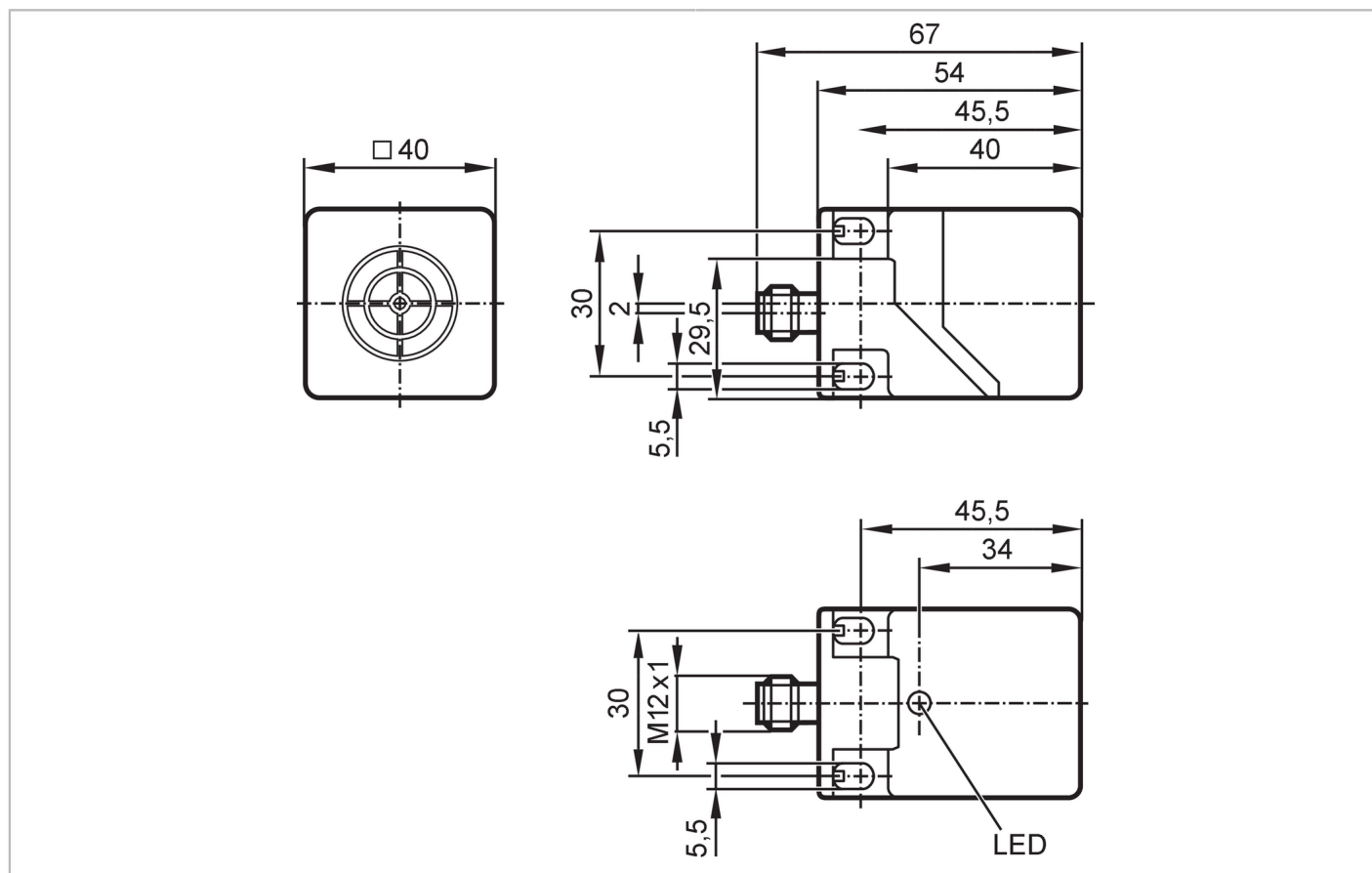

Inductive sensor

IMC4020BCPKG/US/3D/3G



Product characteristics

Electrical design		PNP
Output function		complementary
Sensing range	[mm]	20
Housing		rectangular
Dimensions	[mm]	40 x 40 x 54

Application

System		gold-plated contacts
--------	--	----------------------

Electrical data

Operating voltage	[V]	10...30 DC
Current consumption	[mA]	< 15
Protection class		III
Reverse polarity protection		yes

Outputs

Electrical design		PNP
Output function		complementary
Max. voltage drop switching output DC	[V]	2.5
Max. leakage current	[mA]	0.5

IM512A



Inductive sensor

IMC4020BCPKG/US/3D/3G

Permanent current rating of switching output DC [mA]	200
Switching frequency DC [Hz]	100
Short-circuit protection	yes
Type of short-circuit protection	yes (non-latching)
Overload protection	yes

Monitoring range

Sensing range [mm]	20
Real sensing range Sr [mm]	20 ± 10 %
Operating distance [mm]	0...16.2

Accuracy / deviations

Correction factor	steel: 1 / stainless steel: 0.7 / brass: 0.4 / aluminum: 0.3 / copper: 0.2
Hysteresis [% of Sr]	1...20
Switch-point drift [% of Sr]	-10...10

Operating conditions

Ambient temperature [°C]	-20...60
Protection	IP 65; IP 67

Tests / approvals

Approval	BVS 20 ATEX E 057 X; IECEx BVS 20.0044X
ATEX marking	 II 3G Ex ec IIC T4 Gc
	 II 3D Ex tc IIIC T95°C Dc
EMC	EN 60947-5-2
MTTF [years]	1326

Mechanical data

Weight [g]	179
Housing	rectangular
Mounting	flush mountable
Dimensions [mm]	40 x 40 x 54
Material	housing: PC black; sensing face: PC black; Mounting adapter: PA orange; connection module: PA black; screw: steel galvanized

Displays / operating elements

Display	Switching status	1 x LED, yellow
---------	------------------	-----------------

Accessories

Items supplied	Protective cap: 1 x M12x1, steel
----------------	----------------------------------

Remarks

Pack quantity	1 pcs.
---------------	--------

Electrical connection - plug

Connector: 1 x M12; coding: A; Contacts: gold-plated



IM512A



Inductive sensor

IMC4020BCPKG/US/3D/3G

Connection

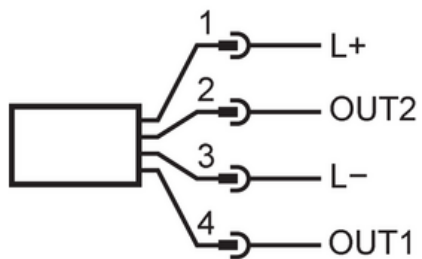

1	L+	
2	OUT2	DO2 (NC)
3	L-	
4	OUT1	DO1 (NO)