

E80342

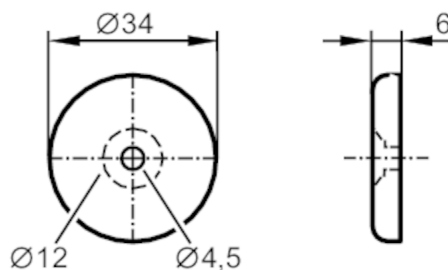

RFID tag

ID-TAG/34X6.0/06



Application

Operating temperature (active)	[°C]	-40...85
Peak temperature (passive)	[°C]	100

Electrical data

Operating frequency	[MHz]	13,56
Memory size	[bit]	896
Memory type		EEPROM
Chip type		ICODE SLIX
Number of the blocks		28
Block size	[Byte]	4
Unique Identification Number (UID)	[Byte]	8
RFID standard		ISO 15693
Max. read cycles		unlimited
Max. write cycles		100000

Operating conditions

Ambient temperature	[°C]	-40...85
Storage temperature	[°C]	-40...100
Protection		IP 68

Tests / approvals

Shock resistance	DIN IEC 68-2-27	40 g 18 ms
Vibration resistance	DIN IEC 68-2-6	10 g 10...2000 Hz
Radio approval		ISO 15693

Mechanical data

Weight	[g]	67.2
Type of mounting		Installation on metal and non-metal materials; (screw fastening ; sticking to a surface)
Dimensions	[mm]	Ø 34 / L = 6
Material		PA 6

Remarks

Remarks		
Pack quantity		10 pcs.

E80342



RFID tag

ID-TAG/34X6.0/06

Other data

Reading distance when mounted on non-metal (mm)

ANT410 / DTI410	6
ANT411 / DTI411	12
ANT420 / DTI420 / DTM424 / DTI424 / DTM426	6
ANT421 / DTI421 / DTM425 / DTI425 / DTM427	25
ANT430 / DTI430 / DTM434 / DTI434 / DTM436	20
ANT431 / DTI431 / DTM435 / DTI435 / DTM437	30
ANT513 / DTI513 / DTC510	45
ANT515 / DTI515 / ANT516 / DTI516	20
ANT600 / DTI600	-

read distance when mounted on metal (mm)

ANT410 / DTI410	5
ANT411 / DTI411	10
ANT420 / DTI420 / DTM424 / DTI424 / DTM426	5
ANT421 / DTI421 / DTM425 / DTI425 / DTM427	25
ANT430 / DTI430 / DTM434 / DTI434 / DTM436	10
ANT431 / DTI431 / DTM435 / DTI435 / DTM437	25
ANT513 / DTI513 / DTC510	40
ANT515 / DTI515 / ANT516 / DTI516	15