

# E30560

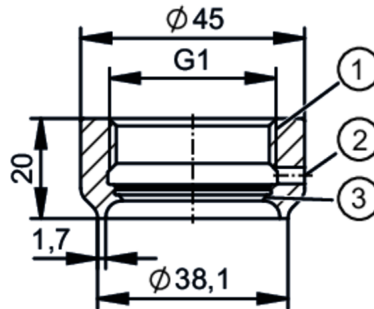

## Welding adapter for process sensors

WELD ADAPT COLLAR G1 ASEPT PIPE ASME 1,5



- 1 G1 Internal thread Aseptoflex Vario
- 2 Leakage port
- 3 sealing area



Application	
Design	with leakage port (3A)
Installation	for pipes
Pressure rating	40 bar   4 MPa
Note on pressure rating	for the connection sensor - adapter professional welding according to operating instructions
Tests / approvals	
Pressure equipment directive	A possible classification to PED depends on the application and has to be carried out by the user / operator.
Safety instructions	The compatibility between medium and product material has to be checked in all applications.
Mechanical data	
Weight [g]	157.7
Materials (wetted parts)	stainless steel (1.4435 / 316L)
Sensor connection	G 1 Internal thread Aseptoflex Vario
Process connection	Welding adapter 1,5" (38,1 x 1,65); dimensions according to DIN 11866 series C ASME-BPE
Surface characteristics Ra/Rz of the wetted parts	Ra < 0.8 µm / Rz = 4 µm
Sealing	Gasket
Accessories	
Items supplied	O-rings: 1 x (24 x 2 mm), EPDM, E30054
Accessories (optional)	O-ring 1 x 24 x 2, FKM, E30123
Remarks	
Pack quantity	1 pcs.