

E11795

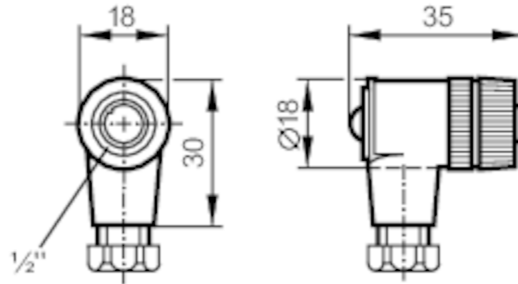

Female wirable connectors

SDOAA030MSSFKPG



Application	
System	Free from silicone; gold-plated contacts
Free from silicone	yes
Electrical data	
Operating voltage [V]	< 250 AC
Max. current load total [A]	4; (...40 °C)
Operating conditions	
Ambient temperature [°C]	-25...85
Protection	IP 67
Mechanical data	
Weight [g]	24.8
Dimensions [mm]	35 x 20 x 30
Molded-body material	PA
Material nut	brass, nickel-plated
Remarks	
Pack quantity	1 pcs.

E11795



Female wirable connectors

SDOAA030MSSFKPG

Electrical connection

terminals: ...0.75 mm²; Cable sheath: Ø 4...6 mm

Electrical connection - Socket

Connector: 1 x 1/2", angled; coding: C; Moulded body: PA; Locking: brass, nickel-plated; Contacts: gold-plated

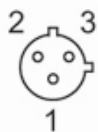

Connection

