

AC2250

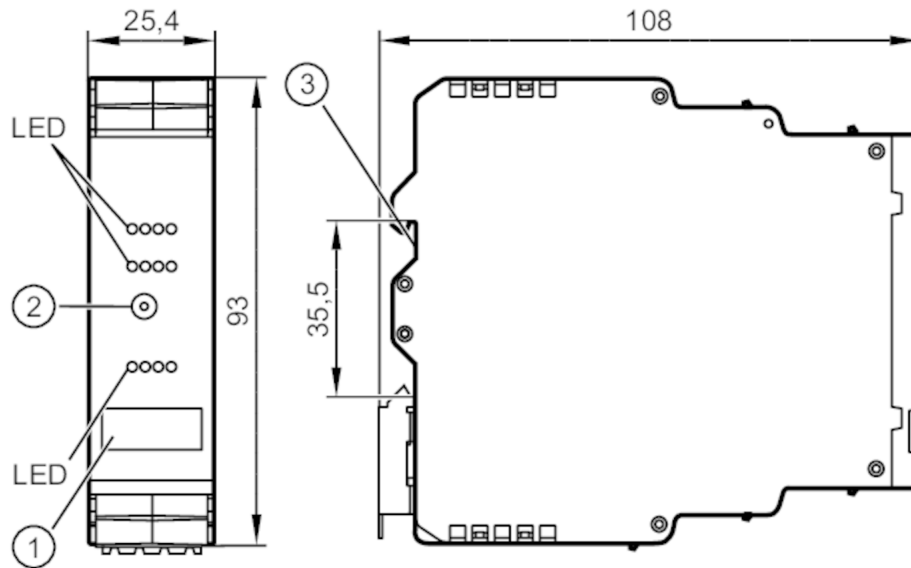

AS-Interface control cabinet module

SmartL25 4DI C



- 1 panel for labelling
- 2 Addressing socket
- 3 DIN rail adapter



Application	
Design	housing for DIN rail mounting
Application	I/O modules for control cabinet installations
Electrical data	
Operating voltage [V]	26.5...31.6 DC
Max. current consumption from AS-i [mA]	250
Inputs / outputs	
Number of inputs and outputs	Number of digital inputs: 4
Inputs	
Number of digital inputs	4
Input circuit of digital inputs	PNP; (type 2 according to IEC 61131-2)
Sensor supply of the inputs	AS-i
Voltage supply [V]	18...30; (DC)
Max. total current rating of inputs [mA]	200
Input current High [mA]	6...10
Input current low [mA]	0...2
Switching level high [V]	> 11

AC2250



AS-Interface control cabinet module

SmartL25 4DI C

Digital inputs protected against short circuits	yes										
Operating conditions											
Ambient temperature [°C]	-25...70										
Max. relative air humidity [%]	90; (non condensing)										
Max. height above sea level [m]	2000										
Protection	IP 20										
Degree of soiling	2										
Tests / approvals											
EMC	EN 61000-6-2										
	EN 62026-2										
	EN 50581										
MTTF [years]	391										
AS-i classification											
AS-i version	2.11; 3.0										
AS-i addressing	Addressing socket										
Extended addressing mode	yes										
AS-i master profile	M2; M3; M4										
AS-i profile	S-0.A.E										
AS-i I/O configuration [hex]	0										
AS-i ID code [hex]	A.E										
AS-i certificate	35401										
Data bits	<table border="1"><thead><tr><th>Data bit</th><th>D0</th><th>D1</th><th>D2</th><th>D3</th></tr></thead><tbody><tr><td>Input</td><td>I-1</td><td>I-2</td><td>I-3</td><td>I-4</td></tr></tbody></table>	Data bit	D0	D1	D2	D3	Input	I-1	I-2	I-3	I-4
Data bit	D0	D1	D2	D3							
Input	I-1	I-2	I-3	I-4							
Mechanical data											
Weight [g]	136										
Housing	rectangular										
Type of mounting	Mounting on DIN rail; (TH35 (EN 60715))										
Dimensions [mm]	93 x 25.4 x 108										
Material	PC-GF20										
Displays / operating elements											
Display	Switching status	LED, yellow I1...I4									
	Power	LED, green AS-i									
	errors	LED, red									
Accessories											
Accessories (optional)	connector										
Remarks											
Remarks	Do not connect any of the following points to an external potential: I-, I+, I1, I2, I3, I4 The connections are electrically connected with the AS-i cable.										
Pack quantity	1 pcs.										

AC2250



AS-Interface control cabinet module

SmartL25 4DI C

Electrical connection

pin header:

Connection

I-	I-	I-	I-
I1	I2	I3	I4
I+	I+	I+	I+

A+	A-		

A+	AS-i +
A-	AS-i -
I+	Sensor supply +24V
I-	Sensor supply 0V
I1...I4	Switching input sensor 1...4