

Systems >>



3-2505-XX

Output Module Option	
1C	Pulse divider/flow switch/totalizer - Dry-contact relay
2C	Pulse divider/flow switch/totalizer - Solid state relay
5C	Digital (S ³ L) Output
6C	4 to 20 mA Output

Example Part Number 3-2505-5C

Sensor Electronics in Universal Junction Box, Digital (S³L) Output.

The 2505-XX has the Signet 2537 paddlewheel sensor electronics, mounted in the universal junction box. Use to easily upgrade paddlewheel sensors in the field. The electronics module mounts directly onto the pipe or wall, and is compatible with all GF and third party open collector output sensors with signal levels of 5 to 24 volts and output frequency up to 1000 Hz.

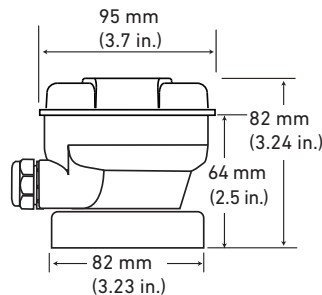

Refer to the Signet Measurement and Control Product Catalog for additional information regarding the 2537 technical specifications.

Any Compatible Signet Flow Sensor (2536 shown)

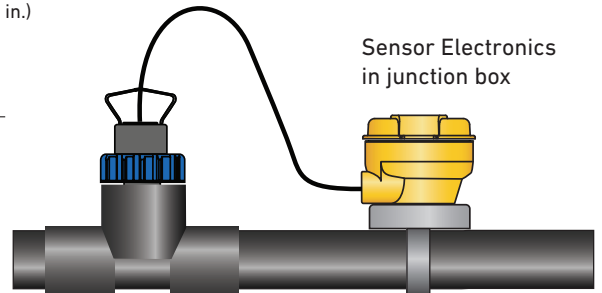

- Compatible Signet Flow Sensors
 2000 2100 2507 2536
 2540 2551 2552

Electrical		
Multi	With Dry-Contact Relay	24 VDC nominal, ±10%, regulated, 30 mA max current
	With Solid-State Relay	6 V to 24 VDC, ±10%, regulated, 30 mA max current
	Digital (S ³ L)	5.0 VDC min to 6.5 VDC max., 30 mA max current (1.5 mA nominal)
	4 to 20 mA	400 mV max ripple voltage, 30 mA max current
	Maximum Pulse Rate	300 Hz
	Maximum Pulse Width	50 ms
	Minimum Pulse Rate	0.5 Hz
Compatible with PLC, PC or similar equipment		
Compatible with customer supplied metering pump		
Digital (S ³ L) Version		5 VDC nominal, regulated, 3 mA max current
Type		Serial ASCII, TTL level 9600 bps
Max. Cable Length		Refer to Signet 8900 wiring specifications.
Compatible with Model		Signet 8900 Multi-Parameter Controller
4 to 20 mA Version		12 to 32 VDC nominal, ±10%, regulated, 21 mA max current
Loop Accuracy		±32 µA @ 25 °C @ 24 VDC
Loop Resolution		5 µA
Temp. Drift		±1 µA per °C max.

Power Supply Rejection	±1µA per V	
Max. Cable	305 m	1000 ft
Maximum Loop Resistance	600 Ω @ 24 VDC	1 KΩ @ 32 VDC
Load Impedance	375 Ω	
Reverse Polarity and Short Circuit Protected	Up to 40 V, 1 hour	
Over-voltage Protection	> 40 VDC over 1 hour	
Relay Specifications		
Mechanical SPDT	5 A @ 30 VDC, 5 A @ 250 VAC	
Solid-State Relay	100 mA @ 40 VDC, 70 mA @ 33 VAC	
Relay Modes	Low, High	
Time Delay	0.0 to 6400.0 seconds	
Hysteresis	Adjustable for exiting alarm condition	
Shipping Weight		
	0.64 kg	1.41 lb
Standards and Approvals		
CE, UL, NSF and FCC		
China RoHS		
Manufactured under ISO 9001 for Quality and ISO 14001 for Environmental Management and OHSAS 18001 for Occupational Health and Safety		

Special order products may not meet all of the specifications of the standard sensor assemblies.