

DIMENSIONAL DATA CONT.

All dimensions are in millimeters unless otherwise noted.

NYLON STRAIN RELIEF

ORDERING INFORMATION

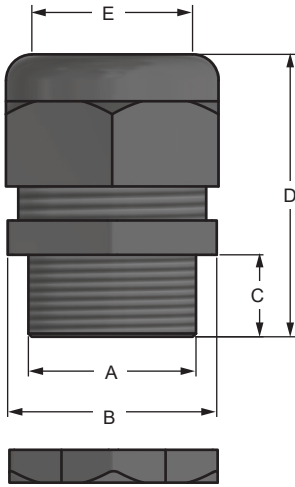

Dimensions					Part Number	
A	B (In)	C (In)	D (In)	E Range (In)	Gray	Black
PG-7	0.630	0.315	1.181	0.118-0.256"	CANTOP-S011	CANTOP-S012
				0.079-0.197"	CANTOP-S021	CANTOP-S022
PG-9	0.748	0.315	1.339	0.157-0.315"	CANTOP-S031	CANTOP-S032
				0.079-0.236"	CANTOP-S041	CANTOP-S042
PG-11	0.866	0.315	1.378	0.197-0.394"	CANTOP-S051	CANTOP-S052
				0.118-0.276"	CANTOP-S061	CANTOP-S062
PG-13.5	0.945	0.354	1.457	0.236-0.472"	CANTOP-S071	CANTOP-S072
				0.197-0.354"	CANTOP-S081	CANTOP-S082
PG-16	1.063	0.394	1.575	0.394-0.551"	CANTOP-S091	CANTOP-S092
				0.276-0.472"	CANTOP-S101	CANTOP-S102
PG21	1.299	0.394	1.772	0.512-0.709"	CANTOP-S111	CANTOP-S112
				0.354-0.630"	CANTOP-S121	CANTOP-S122
PG-29	1.654	0.472	2.047	0.709-0.984"	CANTOP-S131	CANTOP-S132
				0.512-0.787"	CANTOP-S141	CANTOP-S142
PG-36	2.087	0.551	2.441	0.866-1.260"	CANTOP-S151	CANTOP-S152
				0.787-1.024"	CANTOP-S161	CANTOP-S162
PG-42	2.402	0.551	2.480	1.260-1.496"	CANTOP-S171	CANTOP-S172
				0.984-1.220"	CANTOP-S181	CANTOP-S182
PG-48	2.559	0.551	2.520	1.457-1.732"	CANTOP-S191	CANTOP-S192
				1.142-1.378"	CANTOP-S201	CANTOP-S202
NPT 3/8"	0.748	0.591	1.614	0.157-0.315"	CANTOP-S211	CANTOP-S212
				0.079-0.236"	CANTOP-S221	CANTOP-S222
NPT 1/2"	0.945	0.591	1.693	0.236-0.472"	CANTOP-S231	CANTOP-S232
				0.197-0.354"	CANTOP-S241	CANTOP-S242
NPT 3/4"	1.299	0.591	2.047	0.512-0.709"	CANTOP-S251	CANTOP-S252
				0.354-0.630"	CANTOP-S261	CANTOP-S262
NPT 1"	1.614	0.630	2.205	0.709-0.984"	CANTOP-S271	CANTOP-S272
				0.512-0.787"	CANTOP-S281	CANTOP-S282
M12X1.5	0.630	0.315	1.181	0.118-0.256"	CANTOP-S291*	CANTOP-S292*
				0.079-0.197"	CANTOP-S301*	CANTOP-S302*
M16X1.5	0.748	0.315	1.339	0.157-0.315"	CANTOP-S311*	CANTOP-S312*
				0.079-0.236"	CANTOP-S321*	CANTOP-S322*
M18X1.5	0.866	0.315	1.378	0.197-0.394"	CANTOP-S331*	CANTOP-S332*
				0.118-0.276"	CANTOP-S341*	CANTOP-S342*
M20X1.5	0.945	0.354	1.456	0.236-0.472"	CANTOP-S351*	CANTOP-S352*
				0.197-0.354"	CANTOP-S361*	CANTOP-S362*
M22X1.5	1.063	0.394	1.575	0.394-0.551"	CANTOP-S371*	CANTOP-S372*
				0.276-0.472"	CANTOP-S381*	CANTOP-S382*
M25X1.5	1.300	0.394	1.772	0.512-0.709"	CANTOP-S391*	CANTOP-S392*
				0.354-0.630"	CANTOP-S401*	CANTOP-S402*
M32X1.5	1.437	0.433	2.008	0.709-0.984"	CANTOP-S411*	CANTOP-S412*
				0.512-0.787"	CANTOP-S421*	CANTOP-S422*
M40X1.5	2.067	1.575	3.465	0.866-1.260"	CANTOP-S431*	CANTOP-S432*
				0.787-1.024"	CANTOP-S441*	CANTOP-S442*
M50X1.5	2.382	1.575	3.504	1.260-1.496"	CANTOP-S451*	CANTOP-S452*
				0.984-1.220"	CANTOP-S461*	CANTOP-S462*
M63X1.5	2.638	1.575	3.544	1.457-1.732"	CANTOP-S471*	CANTOP-S472*
				1.142-1.378"	CANTOP-S481*	CANTOP-S482*

*Not a stocked item. Consult Factory for availability